

Inductive Sensors  
BES M12MG-GSC30B-BV05  
Order Code: BES0047

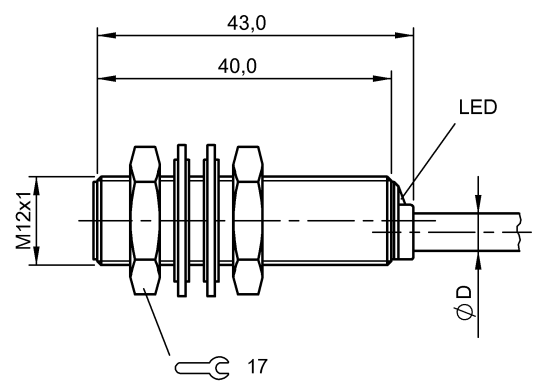

Basic features

Approval/Conformity	cULus CE UKCA WEEE
Basic standard	IEC 60947-5-2
Trademark	Global

Display/Operation

Function indicator	yes
Power indicator	no

Electrical connection

Cable diameter D	4.60 mm
Cable length L	5 m
Conductor cross-section	0.34 mm <sup>2</sup>
Connection type	Cable, 5.00 m, PVC
Number of conductors	2
Polarity reversal protected	yes
Protection against device mix-ups	yes
Short-circuit protection	yes

Electrical data

Load capacitance max. at U <sub>e</sub>	1 µF
Min. operating current I <sub>m</sub>	5 mA
Operating voltage U <sub>b</sub>	10...30 VDC
Rated insulation voltage U <sub>i</sub>	75 V DC
Rated operating current I <sub>e</sub>	100 mA
Rated operating voltage U <sub>e</sub> DC	24 V
Rated short circuit current	100 A
Ready delay t <sub>v</sub> max.	50 ms
Residual current I <sub>r</sub> max.	600 µA
Ripple max. (% of U <sub>e</sub> )	15 %
Switching frequency	1300 Hz
Utilization category	DC -13
Voltage drop static max.	4 V

Environmental conditions

Ambient temperature	-25...70 °C
Contamination scale	3
EN 60068-2-27, Shock	Half-sinus, 30 g <sub>n</sub> , 11 ms
EN 60068-2-6, Vibration	55 Hz, amplitude 1 mm, 3x30 min
IP rating	IP67

Functional safety

MTTF (40 °C)	400 a
--------------	-------

Interface

Switching output	polarized normally open (NO)
------------------	------------------------------

Inductive Sensors  
BES M12MG-GSC30B-BV05  
Order Code: BES0047



Material

Housing material	Brass, Nickel-free coated
Material jacket	PVC
Material sensing surface	PA 12

Mechanical data

Dimension	Ø 12 x 43 mm
Installation	for flush mounting
Mounting length	40.00 mm
Size	M12x1
Tightening torque	15 Nm

Range/Distance

Assured operating distance Sa	2.4 mm
Hysteresis H max. (% of Sr)	20.0 %
Rated operating distance Sn	3 mm
Real switching distance sr	3 mm
Repeat accuracy max. (% of Sr)	5.0 %
Switching distance marking	■ ■
Temperature drift max. (% of Sr)	10 %
Tolerance Sr	±10 %

Remarks

The sensor is functional again after the overload has been eliminated.  
For more information about MTTF and B10d see MTTF / B10d Certificate

Indication of the MTTF- / B10d value does not represent a binding composition and/or life expectancy assurance; these are simply experiential values with no warranty implications. These declared values also do not extend the expiration period for defect claims or affect it in any way.

Wiring Diagrams

