

Field-Attachable Connectors  
BCC M445-0000-1A-000-51X475-000  
Order Code: BCC06Y8

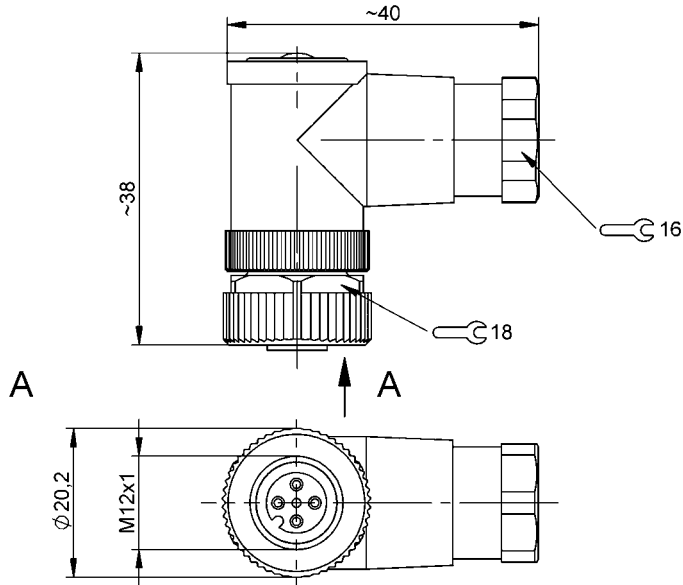

#### Basic features

Approval/Conformity	CE cULus WEEE
---------------------	---------------------

#### Electrical connection

Cable diameter D	6...8 mm
Connection	M12x1-Female, angled, 5-pin, A-coded
Number of connectable contacts	4
System	Can be fabricated

#### Electrical data

Operating voltage $U_b$	250 VDC / 250 VAC
Rated current (40 °C)	4.0 A

#### Environmental conditions

Ambient temperature	-40...85 °C
IP rating	IP67

#### Material

Material contact carrier	PA
Material contacts	Brass
Material cover nut	Die-cast zinc
Material grip	PA

#### Mechanical data

Connection cross-section	0.14...0.75 mm <sup>2</sup>
Tightening torque pigtail	0.6 Nm
Type of wire mounting	Screw terminals

#### Remarks

Enclosure rating per IEC 60529, only in screwed state with the associated mating piece.

### Connector Drawings

