

Field-Attachable Connectors
BCC M343-0000-20-000-34X325-000
Order Code: BCC06Z0

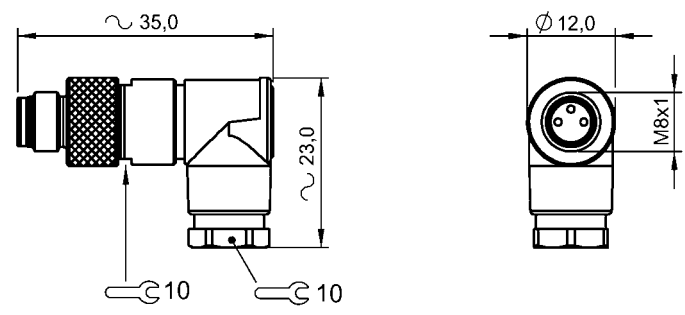

Basic features

Approval/Conformity	CE cULus WEEE
---------------------	---------------------

Electrical connection

Cable diameter D	3.5...5 mm
Connection	M8x1-Male, angled, 3-pin, A-coded
Number of connectable contacts	3
System	Can be fabricated

Electrical data

Operating voltage U_b	60 VDC / 60 VAC
Rated current (40 °C)	4.0 A

Environmental conditions

Ambient temperature	-40...85 °C
IP rating	IP67

Material

Material contact carrier	PA
Material contacts	Brass
Material cover nut	Brass
Material grip	PBT

Mechanical data

Connection cross-section	0.14...0.34 mm ²
Tightening torque pigtail	0.4 Nm
Type of wire mounting	Solder connections

Remarks

Enclosure rating per IEC 60529, only in screwed state with the associated mating piece.

Connector Drawings

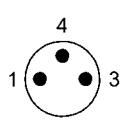

PIN 1-3 usable