

Field-Attachable Connectors
BCC M445-0000-1A-000-51X575-000
Order Code: BCC06ZJ

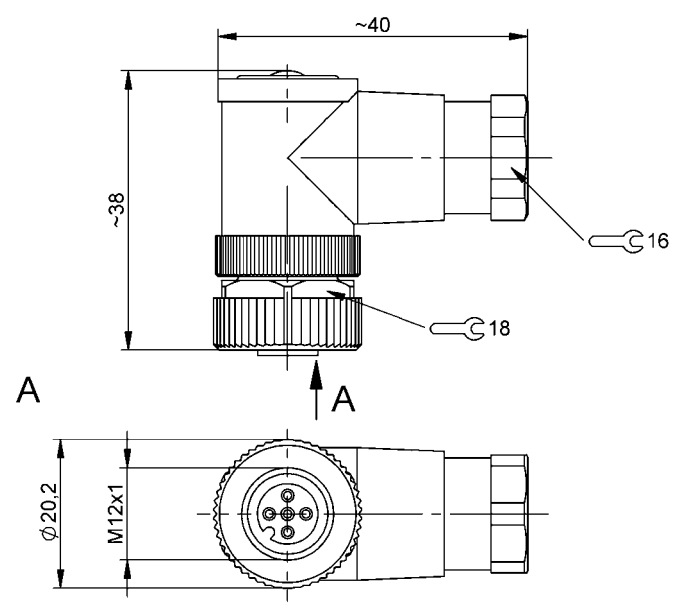

Basic features

| | |
|---------------------|---------------------|
| Approval/Conformity | CE cURus WEEE |
|---------------------|---------------------|

Electrical connection

| | |
|--------------------------------|--------------------------------------|
| Cable diameter D | 6...8 mm |
| Connection | M12x1-Female, angled, 5-pin, A-coded |
| Number of connectable contacts | 5 |
| System | Can be fabricated |

Electrical data

| | |
|-----------------------|-------------------|
| Operating voltage Ub | 125 VDC / 125 VAC |
| Rated current (40 °C) | 4.0 A |

Environmental conditions

| | |
|---------------------|-------------|
| Ambient temperature | -40...85 °C |
| IP rating | IP67 |

Material

| | |
|--------------------------|---------------|
| Material contact carrier | PA |
| Material contacts | Brass |
| Material cover nut | Die-cast zinc |
| Material grip | PA |

Mechanical data

| | |
|---------------------------|-----------------------------|
| Connection cross-section | 0.14...0.75 mm ² |
| Tightening torque pigtail | 0.6 Nm |
| Type of wire mounting | Screw terminals |

Remarks

Enclosure rating per IEC 60529, only in screwed state with the associated mating piece.

Connector Drawings

