

Single-Ended Cordsets
BCC A314-0000-10-072-VX44W6-150
Order Code: BCC092L

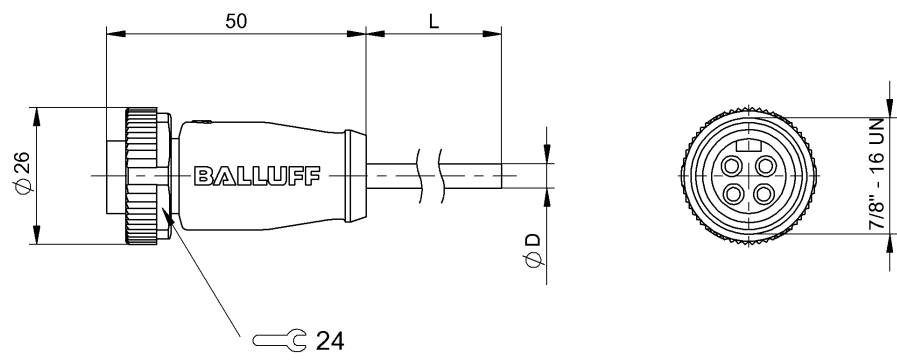

Basic features

Application	Operating voltage
Approval/Conformity	CE cULus WEEE

Electrical connection

Cable	PVC Yellow, 15 m
Cable diameter D	10.67 mm ±0.25 mm
Conductor cross-section	16 AWG
Connection	7/8"-Female, straight, 4-pin
Connector configuration	Straight
Number of conductors	4
Number of pins	4
System	Molded

Electrical data

Cable rated voltage AC max.	600 V
Cable rated voltage DC max.	600 V
Operating voltage Ub	300 VDC / 300 VAC
Operating voltage Ub 3-phase network	277/480V AC +/- 15%
Rated current (40 °C)	10.0 A

Remarks

Bulk cable: PVC UL listed, 16/4 ST00W/Male00W CSA 105°C 600 V
Enclosure rating per IEC 60529, only in screwed state with the associated mating piece.

Environmental conditions

Cable temperature, fixed routing	-40...105 °C
IP rating	IP67, IP68

Material

Cable jacket, material	PVC
Material contact carrier	PUR
Material contacts	Brass
Material cover nut	Die-cast zinc
Material grip	PUR

Mechanical data

Cable jacket, color	Yellow
Cable length L	15.00 m
Tightening torque pigtail	1.5 Nm

Connector Drawings

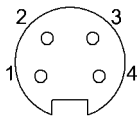

PIN 1: black
PIN 2: white
PIN 3: red
PIN 4: green

Wiring Diagrams

