

Double-Ended Cordsets
BCC A315-A315-30-330-VS85N6-040
Order Code: BCC09YH

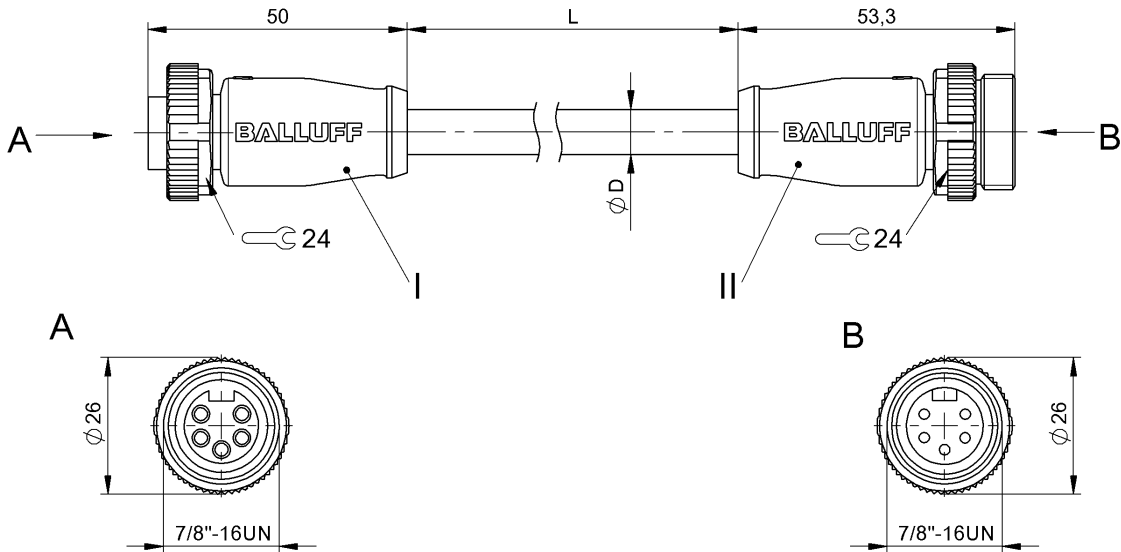

Basic features

Application	DeviceNet Thin
Approval/Conformity	CE cULus WEEE

Electrical connection

Cable	PVC Shielded gray, 4 m
Cable diameter D	7.20 mm ±0.13 mm
Conductor cross-section	22 AWG
Connection 1	7/8"-Female, straight, 5-pin
Connection 2	7/8"-Male, straight, 5-pin
Number of conductors	4
System	Molded/Molded

Electrical data

Cable rated voltage AC max.	300 V
Cable rated voltage DC max.	300 V
Conductor construction	2x2 twisted-pair
Operating voltage Ub	300 VDC / 300 VAC
Rated current (40 °C)	4.0 A
Surge impedance	120 Ohm ±12 Ohm

Remarks

Cable construction acc. to CMG 75°C or CL2
Flame resistant per UL 1685 (CSA FT4)
Enclosure rating per IEC 60529, only in screwed state with the associated mating piece.

Environmental conditions

Ambient temperature	-20...80 °C
IP rating	IP67, IP68/IP67, IP68

Material

Cable jacket material, note	Shielded
Cable jacket, material	PVC
Cable shield	Aluminum foil and copper braid
Material contact carrier	PUR/PUR
Material contacts	Brass/Brass
Material cover nut	Die-cast zinc/Die-cast zinc
Material grip	PUR/PUR

Mechanical data

Cable jacket, color	gray
Cable length L	4.00 m
Tightening torque pigtail	1.5 Nm/1.5 Nm

Connector Drawings

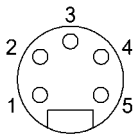

DeviceNet Output

PIN 1: shield
PIN 2: +24V
PIN 3: 0V
PIN 4: CAN H
PIN 5: CAN L

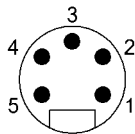

DeviceNet Input

PIN 1: shield
PIN 2: +24V
PIN 3: 0V
PIN 4: CAN H
PIN 5: CAN L

Wiring Diagrams

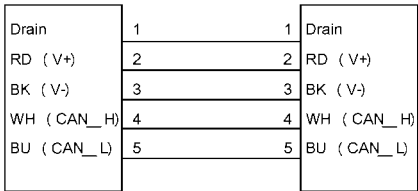

L