

Ultrasonic Sensors  
BUS R06K1-XB-12/070-S75G  
Order Code: BUS005C

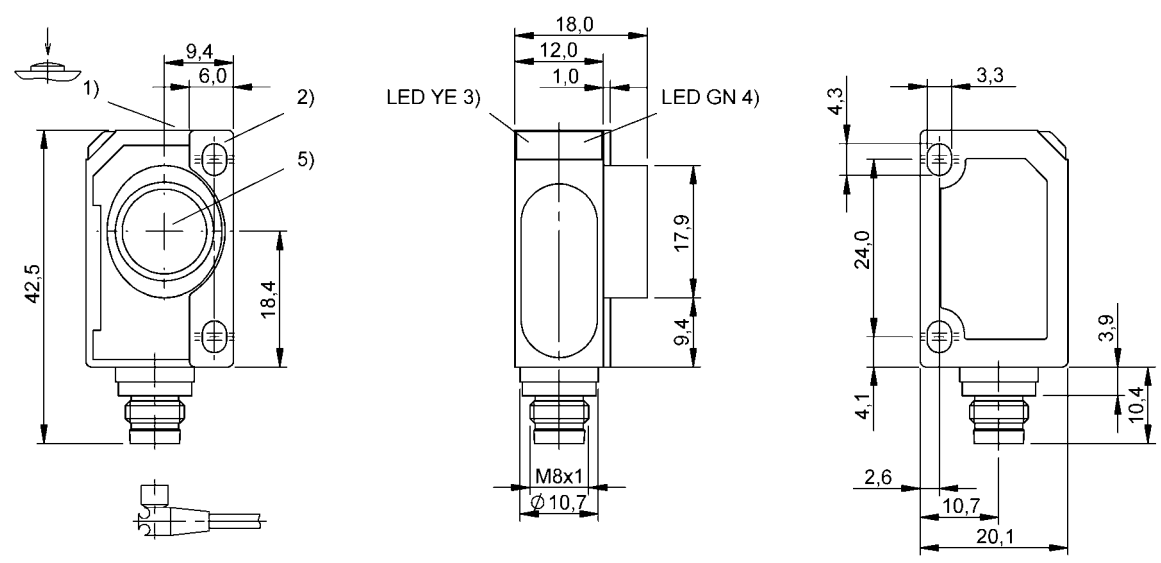

1) Set sensor, 2) Mounting plate, 3) Status indicator, 4) Operating voltage/mode, 5) Ultrasonic transducer axis



Basic features

Application	Distance measurement
Approval/Conformity	CE WEEE UKCA
Operating mode	Analog measurement (output curve)
Series	R06K1

Display/Operation

Adjuster	button
Display	Mode - LED green, flashing LED green: Power Object in range - LED yellow
Setting	Key disable on/off Factory setting (Reset) Output curve rising/falling Output curve window

Electrical connection

Connection	M8x1-Male, 4-pin
Polarity reversal protected	yes

Electrical data

Current draw max.	35 mA
Input function	Synchronization signal
Load resistance RL max. (Analog I)	500 ohms
Operating voltage Ub	20...30 VDC
Rated operating voltage Ue DC	24 V
Synchronization	external, any number of sensors
Ultrasonic Frequency	300 kHz

Environmental conditions

Ambient temperature	-25...70 °C
IP rating	IP67
Storage temperature	-40...85 °C

Functional safety

MTTF (40 °C)	516 a
--------------	-------

Interface

Analog output	Analog, current 4...20 mA
Output characteristic	linear rising/falling

Material

Housing material	ABS, nickel-plated
Material sensing surface	PU foam/Epoxy resin/Glass
Surface protection	nickel-plated

Mechanical data

Dimension	20.1 x 42.5 x 18 mm
Mounting part	Screw M3

Range/Distance

Measuring range	120...1000 mm
Rated operating distance Sn	700 mm
Repeat accuracy	± 0.15 %FS
Resolution	≤ 0.037 mm

Remarks

For additional information, refer to user's guide.

Order accessories separately.

Do not press key using a pointed tool.

Reference object for Sn: tube ø10mm. Max. range refers to the aligned plate.

The sensor is functional again after the overload has been eliminated.

For more information about MTTF and B10d see MTTF / B10d Certificate

Indication of the MTTF- / B10d value does not represent a binding composition and/or life expectancy assurance; these are simply experiential values with no warranty implications. These declared values also do not extend the expiration period for defect claims or affect it in any way.

Connector Drawings



Wiring Diagrams

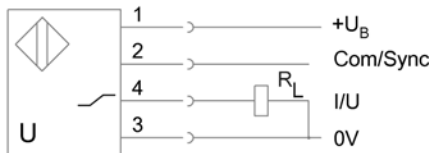

Ultrasonic Sensors  
BUS R06K1-XB-12/070-S75G  
Order Code: BUS005C



Technical Drawings

