

Photoelectric Sensors  
BOS 6K-XT-RS10-S75  
Order Code: BOS01LR

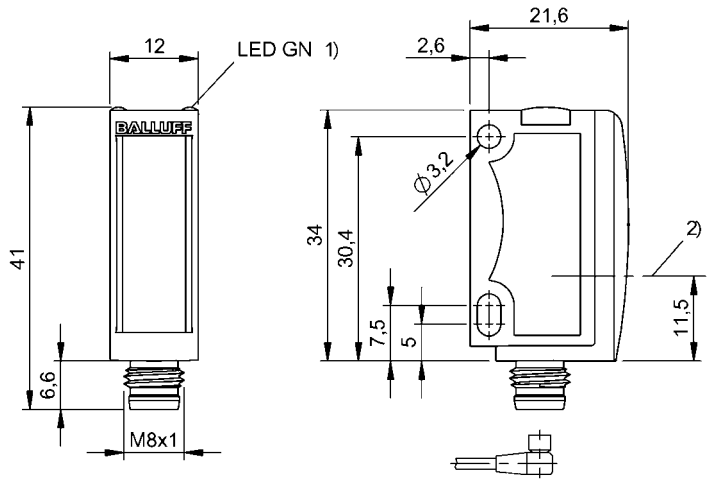

1) Operating voltage, 2) Optical axis



Basic features

Approval/Conformity	cULus CE WEEE
Basic standard	IEC 60947-5-2
Principle of operation	Photoelectric sensor
Reference receiver	BOS 6K-..-RE10-..
Series	6K
Style	Square Connection 90°

Display/Operation

Display	LED green: Power
---------	------------------

Electrical connection

Connection	Connector, M8x1-Male, 4-pin
Polarity reversal protected	yes
Protection against device mix-ups	yes

Electrical data

No-load current I <sub>o</sub> max. at U <sub>e</sub>	30 mA
Operating voltage U <sub>b</sub>	10...30 VDC
Protection class	II
Rated operating voltage U <sub>e</sub> DC	24 V
Ripple max. (% of U <sub>e</sub> )	12 %

Environmental conditions

Ambient temperature	-20...60 °C
EN 60068-2-27, Shock	Half-sinus, 30 g <sub>n</sub> , 11 ms, 3x6
EN 60068-2-6, Vibration	10...55 Hz, amplitude 0.5 mm, 3x30 min
IP rating	IP67
IP rating per DIN 40050	IP69K

Functional safety

MTTF (40 °C)	499 a
--------------	-------

Material

Housing material	ABS
Material sensing surface	PMMA

Mechanical data

Dimension	12 x 41 x 21.6 mm
Mounting part	Screw M3

Optical features

Beam characteristic	Divergent
Light spot size	1200 x 1200 mm at 15 m
Light type	LED, red light
Principle of optical operation	Through-beam sensor (Emitter)
Wave length	660 nm

Range/Distance	Range	0...13 m
	Rated operating distance Sn	13 m Adjustable

Remarks

Only for applications per NFPA 79 (machines with a supply voltage of maximum 600 V). Use an R/C (CYJV2) cable with suitable properties for attaching the device.

For additional information, refer to user's guide.

Order accessories separately.

When using as a UL product the ambient temperature Ta max. must not exceed 50°C.

For more information about MTTF and B10d see MTTF / B10d Certificate

Indication of the MTTF- / B10d value does not represent a binding composition and/or life expectancy assurance; these are simply experiential values with no warranty implications. These declared values also do not extend the expiration period for defect claims or affect it in any way.

Connector Drawings



Wiring Diagrams

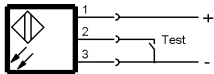

Opto Symbols

