

Receptacles
BCC M454-0000-2A-RM020-020
Order Code: BCC0E53

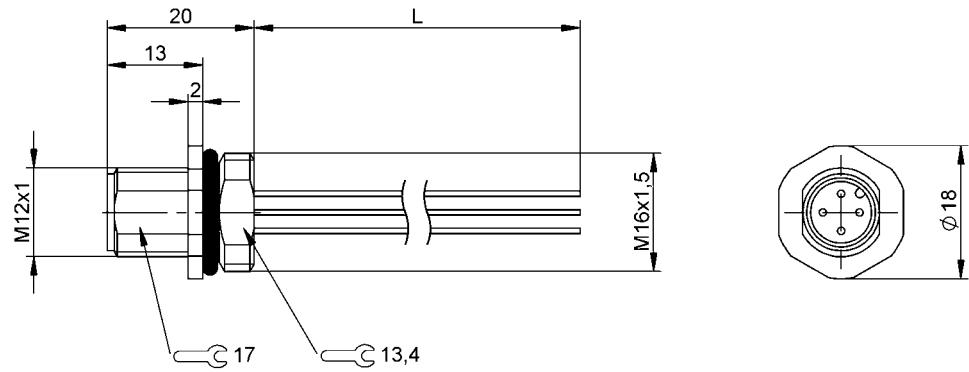

Basic features

Approval/Conformity	CE WEEE
---------------------	------------

Electrical connection

Conductor cross-section	0.25 mm ²
Connection	M12x1-Male, straight, 4-pin, A-coded
Number of conductors	4

Electrical data

Operating voltage U _b	250 VDC / 250 VAC
Rated current (40 °C)	4.0 A

Environmental conditions

Ambient temperature	-40...85 °C
IP rating	IP68

Material

Conductor insulation material	TPE
Housing material	Die-cast zinc, nickel-plated
Housing material, surface protection	nickel-plated
Material contact carrier	PA
Material contacts	Brass

Mechanical data

Lead length L	2.00 m
Mounting part	M16x1.5

Remarks

Enclosure rating per IEC 60529, only in screwed state with the associated mating piece.
Nut M16 included in scope of delivery

Connector Drawings

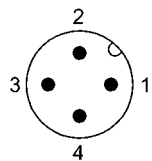

PIN 1: brown
PIN 2: white
PIN 3: blue
PIN 4: black

Wiring Diagrams

