

Adapters  
BCC M314-M414-3E-RA102-000  
Order Code: BCC0F2Y

BALLUFF

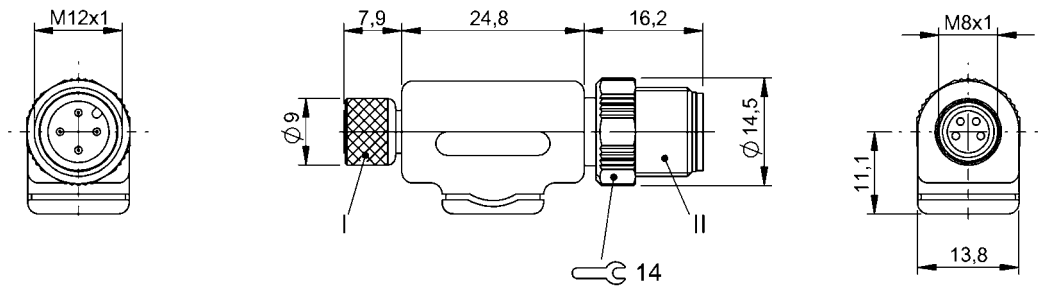

Basic features

Approval/Conformity	WEEE
---------------------	------

Electrical connection

Connection 1	M8x1-Female, straight, 4-pin, A-coded
Connection 2	M12x1-Male, straight, 4-pin, A-coded
Connector 01, version	straight
Connector 02, version	straight
Number of pins	4/4

Electrical data

Operating voltage $U_b$	30 VDC / 30 VAC
Rated current (40 °C)	3.0 A

Environmental conditions

Ambient temperature	-25...85 °C
IP rating	IP67

Material

Material cover nut	Brass/Die-cast zinc
Material grip	TPU

Mechanical data

Tightening torque pigtail	0.4 Nm/0.6 Nm
---------------------------	---------------

Remarks

Enclosure rating per IEC 60529, only in screwed state with the associated mating piece.

Connector Drawings

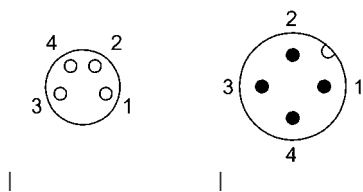

Wiring Diagrams

