

Bulkhead Connectors
BCC M455-M455-3A-RM103-000
Order Code: BCC0F45

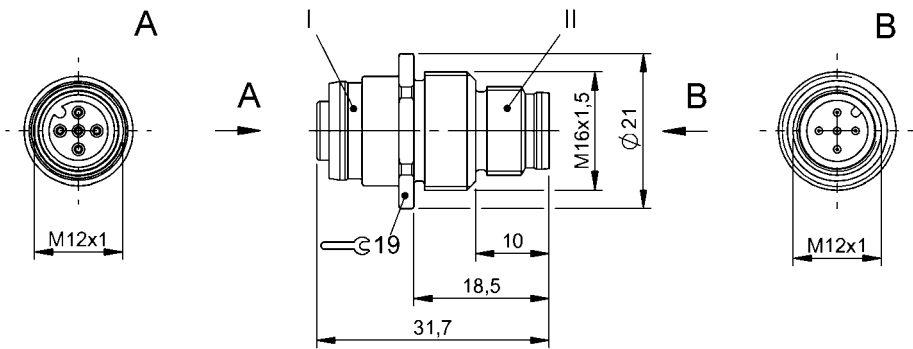

Basic features

Approval/Conformity	CE WEEE
---------------------	------------

Electrical connection

Connection 1	M12x1-Female, straight, 5-pin, A-coded
Connection 2	M12x1-Male, straight, 5-pin, A-coded
Connector 01, version	straight
Connector 02, version	straight
Number of pins	5/5

Electrical data

Operating voltage U_b	60 VDC / 60 VAC
Rated current (40 °C)	4.0 A

Remarks

Enclosure rating per IEC 60529, only in screwed state with the associated mating piece.
The following are included for installation: 1x O-ring and 1x hex nut 18mm flat-to-flat

Environmental conditions

Ambient temperature	-25...80 °C
IP rating	IP67/IP67

Material

Material contact carrier	PA 6.6
Material contacts	Brass
Material cover nut	Brass
Material grip	Brass

Mechanical data

Mounting part	M16x1.5
---------------	---------

Connector Drawings

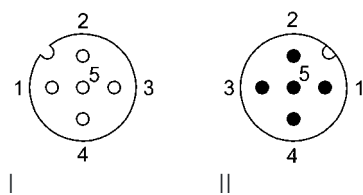

Wiring Diagrams

