

Field-Attachable Connectors
BCC M434-0000-2A-000-45X450-000
Order Code: BCC0F9M

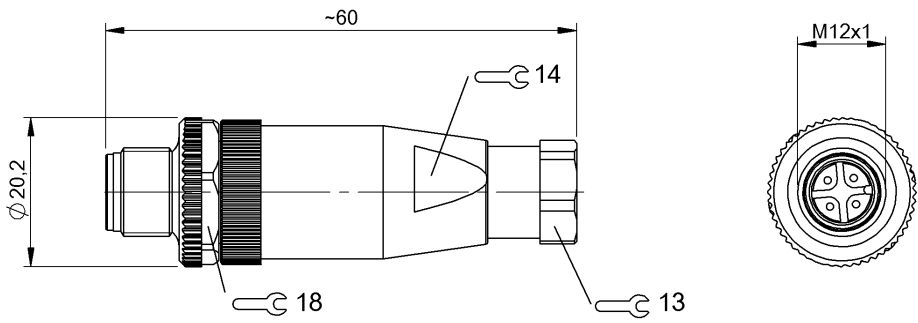

Basic features

Approval/Conformity	CE WEEE
---------------------	------------

Electrical connection

Cable diameter D	4...6 mm
Connection	M12x1-Male, straight, 4-pin, A-coded
Number of connectable contacts	4
System	Can be fabricated

Electrical data

Operating voltage U_b	250 VDC / 250 VAC
Rated current (40 °C)	4.0 A

Environmental conditions

Ambient temperature	-40...85 °C
IP rating	IP67

Material

Material contact carrier	PA
Material contacts	Brass
Material cover nut	Die-cast zinc
Material grip	PA

Mechanical data

Connection cross-section	0.14...0.5 mm ²
Tightening torque pigtail	0.6 Nm
Type of wire mounting	Spring clamp terminals

Remarks

Enclosure rating per IEC 60529, only in screwed state with the associated mating piece.

Connector Drawings

