

Bulkhead Connectors  
BCC M458-M458-3A-RM141-000  
Order Code: BCC0K3P

**BALLUFF**

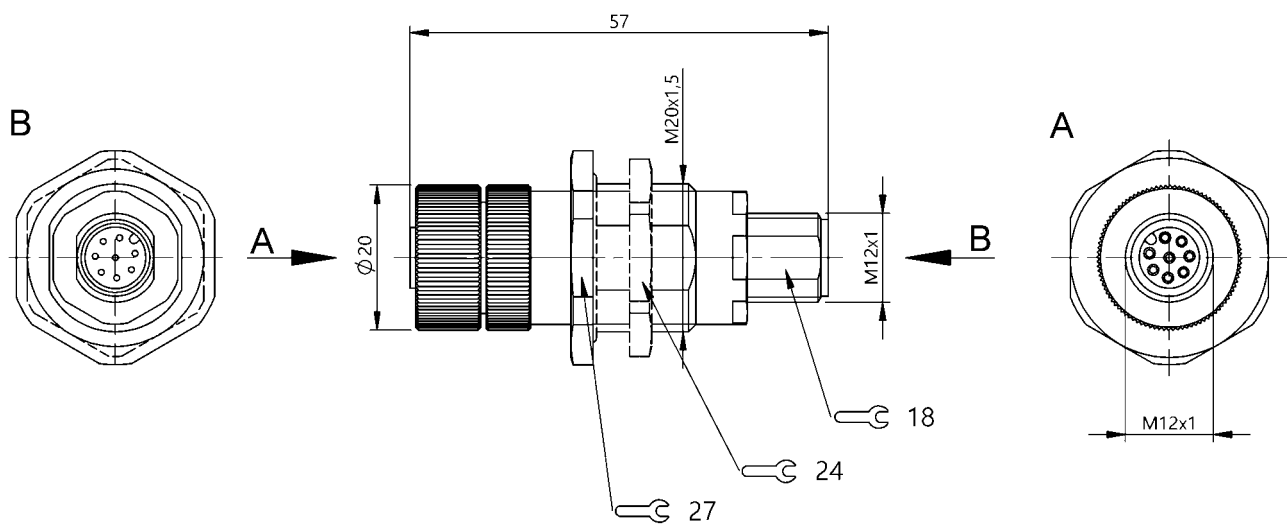

#### Basic features

Approval/Conformity	WEEE
---------------------	------

#### Electrical connection

Connection 1	M12x1-Female, straight, 8-pin, A-coded
Connection 2	M12x1-Male, straight, 8-pin, A-coded
Connector 01, version	straight
Connector 02, version	straight
Number of pins	8/8

#### Electrical data

Operating voltage $U_b$	30 VDC / 30 VAC
Rated current (40 °C)	2.0 A

#### Environmental conditions

Ambient temperature	-25...80 °C
IP rating	IP67/IP67

#### Material

Material contact carrier	PA/PA
Material contacts	Brass/Bronze
Material grip	Nickel-plated brass
	Die-cast zinc/Nickel-plated brass
	Die-cast zinc

#### Mechanical data

Mounting part	M20x1.5
Tightening torque pigtail	1.0...1.2 Nm

#### Remarks

Enclosure rating per IEC 60529, only in screwed state with the associated mating piece.  
The following are included for installation: 1x O-ring and 1x hex nut 24mm flat-to-flat

#### Connector Drawings

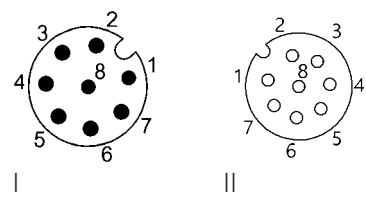

Wiring Diagrams

