

Inductive Sensors

BES M30N1-PSC10B-GT05-T
Order Code: BES05N5

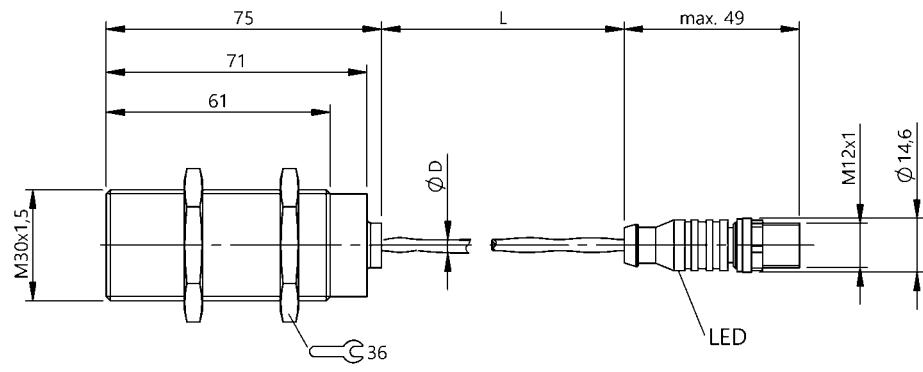

Basic features

Approval/Conformity	CE WEEE UKCA
Basic standard	IEC 60947-5-2

Display/Operation

Function indicator	yes
Power indicator	no

Electrical connection

Cable diameter D	3.5 mm
Cable length L	5 m
Conductor cross-section	0.22 mm ²
Connection	M12x1, 4-pin, A-coded
Connection type	Connector, 5.0 m, PTFE
Number of conductors	3
Polarity reversal protected	yes
Protection against device mix-ups	yes
Short-circuit protection	yes

Electrical data

Load capacitance max. at U _e	9 µF
Min. operating current I _m	0 mA
No-load current I _o max., damped	5 mA
No-load current I _o max., undamped	3 mA
Operating voltage U _b	10...30 VDC
Rated operating current I _e	150 mA
Rated operating voltage U _e DC	24 V
Ready delay t _v max.	13 ms
Residual current I _r max.	20 µA
Ripple max. (% of U _e)	10 %
Switching frequency	9 Hz
Utilization category	DC -13
Voltage drop static max.	1.3 V

Environmental conditions

Ambient temperature	0...230 °C
IP rating	IP50

Functional safety

MTTF (40 °C)	2209 a
--------------	--------

Interface

Switching output	PNP normally open (NO)
------------------	------------------------

Material

Housing material	Stainless steel
Material jacket	PTFE
Material sensing surface	LCP

Inductive Sensors
BES M30N1-PSC10B-GT05-T
Order Code: BES05N5



Mechanical data

Dimension	Ø 30 x 74 mm
Installation	for flush mounting
Mounting length	60.0 mm
Size	M30x1.5

Range/Distance

Assured operating distance Sa	8.1 mm
Hysteresis H max. (% of Sr)	15.0 %
Rated operating distance Sn	10 mm
Real switching distance sr	10 mm
Repeat accuracy max. (% of Sr)	1.6 %
Tolerance Sr	±15 %

Remarks

Connector has a permissible temperature range of -20 °C to +70 °C
For more information about MTTF and B10d see MTTF / B10d Certificate

Indication of the MTTF- / B10d value does not represent a binding composition and/or life expectancy assurance; these are simply experiential values with no warranty implications. These declared values also do not extend the expiration period for defect claims or affect it in any way.

Connector Drawings



Wiring Diagrams

