

Inductive Sensors  
BES 516-300-S240-D-PU-03  
Order Code: BHS002H

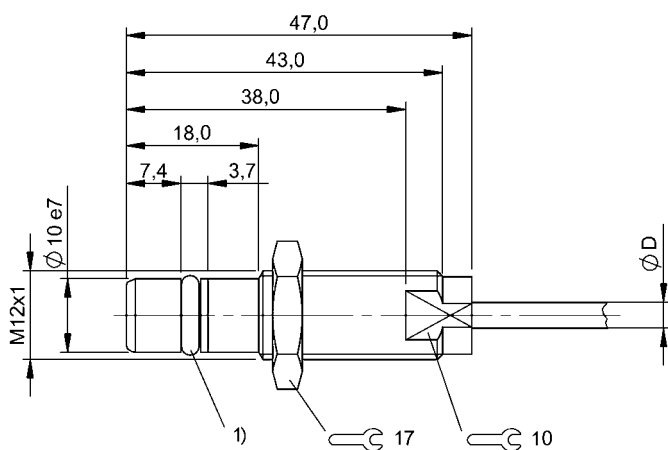

1) O-Ring with thrust ring



Basic features

Approval/Conformity	CE
	UKCA
	cULus
	WEEE
Basic standard	IEC 60947-5-2

Display/Operation

Function indicator	no
Power indicator	no

Electrical connection

Cable diameter D	3.50 mm
Cable length L	3 m
Conductor cross-section	0.14 mm <sup>2</sup>
Connection type	Cable, 3.00 m, PUR
Number of conductors	3
Polarity reversal protected	yes
Protection against device mix-ups	yes
Short-circuit protection	yes

Electrical data

Load capacitance max. at U <sub>e</sub>	1 µF
Min. operating current I <sub>m</sub>	0 mA
No-load current I <sub>o</sub> max., damped	8 mA
No-load current I <sub>o</sub> max., undamped	3 mA
Operating voltage U <sub>b</sub>	10...30 VDC
Output resistance R <sub>a</sub>	150.0 kOhm
Rated insulation voltage U <sub>i</sub>	75 V DC
Rated operating current I <sub>e</sub>	200 mA
Rated operating voltage U <sub>e</sub> DC	24 V
Rated short circuit current	100 A
Ready delay t <sub>v</sub> max.	50 ms
Residual current I <sub>r</sub> max.	10 µA
Ripple max. (% of U <sub>e</sub> )	15 %
Switching frequency	2000 Hz
Utilization category	DC -13
Voltage drop static max.	2.2 V

Environmental conditions

Ambient temperature	-25...80 °C
Contamination scale	3
EN 60068-2-27, Shock	Half-sinus, 30 g <sub>n</sub> , 11 ms
EN 60068-2-6, Vibration	55 Hz, amplitude 1 mm, 3x30 min
IP rating	IP68

Functional safety

MTTF (40 °C)	855 a
--------------	-------

Interface

Switching output PNP normally open (NO)

Material

Housing material Stainless steel  
Material jacket PUR  
Material sensing surface EP  
Support ring material PTFE

Mechanical data

Dimension Ø 12 x 47 mm  
Installation for flush mounting  
Mounting length 20.00 mm  
Mounting part M12x1  
Pressure rating max. 500 bar  
Pressure rating, note oil pressure rated  
Sealing ring, size 5.85 x 2.4 mm  
Size M12x1  
Tightening torque 20 Nm ±10 %

Range/Distance

Assured operating distance Sa 1.2 mm  
Hysteresis H max. (% of Sr) 15.0 %  
Rated operating distance Sn 1.5 mm  
Real switching distance sr 1.5 mm  
Repeat accuracy max. (% of Sr) 5.0 %  
Temperature drift max. (% of Sr) 10 %  
Tolerance Sr ±10 %

Remarks

The sensor is functional again after the overload has been eliminated.  
Installation Instructions 614804  
For more information about MTTF and B10d see MTTF / B10d Certificate

Indication of the MTTF- / B10d value does not represent a binding composition and/or life expectancy assurance; these are simply experiential values with no warranty implications. These declared values also do not extend the expiration period for defect claims or affect it in any way.

Wiring Diagrams

