

Inductive Sensors  
BES M08EB-PSC40F-S49G-539  
Order Code: BES056P

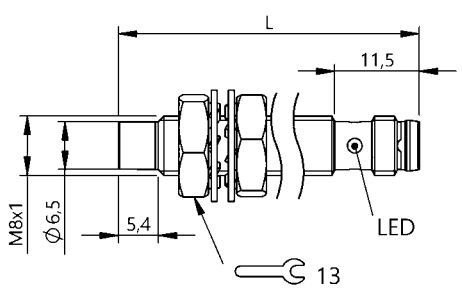

Basic features

Approval/Conformity	CE UKCA cULus WEEE
Base type deviation	Pot core with 2K coating
Basic standard	IEC 60947-5-2

Display/Operation

Function indicator	yes
Power indicator	no

Electrical connection

Connection	M8x1-Male, 3-pin
Polarity reversal protected	yes
Protection against device mix-ups	yes
Short-circuit protection	yes

Electrical data

Load capacitance max. at Ue	1 µF
Min. operating current Im	0 mA
No-load current Io max., damped	7 mA
No-load current Io max., undamped	2 mA
Operating voltage Ub	10...30 VDC
Output resistance Ra	33.0 kOhm
Protection class	II
Rated insulation voltage Ui	250 V AC
Rated operating current Ie	200 mA
Rated operating voltage Ue DC	24 V
Rated short circuit current	100 A
Ready delay tv max.	25 ms
Residual current Ir max.	10 µA
Ripple max. (% of Ue)	10 %
Switching frequency	4000 Hz
Utilization category	DC -13
Voltage drop static max.	2.5 V

Environmental conditions

Ambient temperature	-25...70 °C, Temperature drift max. (% Sr) > 15% valid from 50...70 °C
Contamination scale	3
EN 60068-2-27, Shock	Half-sinus, 30 gn, 11 ms
EN 60068-2-6, Vibration	55 Hz, amplitude 1 mm, 3x30 min
IP rating	IP68

Functional safety

MTTF (40 °C)	595 a
--------------	-------

Inductive Sensors  
BES M08EB-PSC40F-S49G-539  
Order Code: BES056P



Interface

Switching output PNP normally open (NO)

Material

Housing material Stainless steel  
Material sensing surface PBT, 2K coating

Mechanical data

Dimension Ø 8 x 30 mm  
Installation non-flush  
Mounting length 13.00 mm  
Size M8x1  
Tightening torque 8 Nm

Range/Distance

Assured operating distance Sa 3.2 mm  
Hysteresis H max. (% of Sr) 15.0 %  
Rated operating distance Sn 4 mm  
Real switching distance sr 4 mm  
Repeat accuracy max. (% of Sr) 5.0 %  
Switching distance marking ■■  
Temperature drift max. (% of Sr) 10 %  
Tolerance Sr ±10 %

Remarks

Not for flush mounting: See installation instructions for inductive sensors with extended range 939229.  
The sensor is functional again after the overload has been eliminated.  
In rare cases, the function of the sensor may be impaired during contact with water  
it is fully functional again after drying  
For more information about MTTF and B10d see MTTF / B10d Certificate

Indication of the MTTF- / B10d value does not represent a binding composition and/or life expectancy assurance; these are simply experiential values with no warranty implications. These declared values also do not extend the expiration period for defect claims or affect it in any way.

Connector Drawings



Wiring Diagrams

