

Inductive Sensors
BES G06MH-PSC30B-BP00,3-GS49
Order Code: BES03EJ

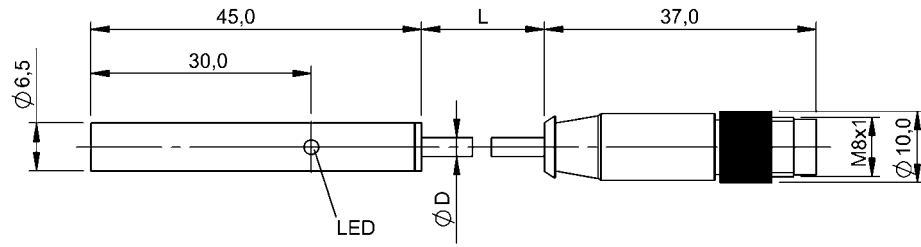

Basic features

Approval/Conformity	CE WEEE
Basic standard	IEC 60947-5-2

Display/Operation

Function indicator	yes
Power indicator	no

Electrical connection

Cable diameter D	3.20 mm
Cable length L	0.3 m
Connection	M8x1-Male, 3-pin
Connection type	Cable with connector, 0.30 m, PUR
Polarity reversal protected	yes
Protection against device mix-ups	yes
Short-circuit protection	yes

Electrical data

Load capacitance max. at Ue	1 µF
Min. operating current Im	0 mA
No-load current Io max., damped	12 mA
No-load current Io max., undamped	10 mA
Operating voltage Ub	10...30 VDC
Output resistance Ra	47.0 kOhm
Rated insulation voltage Ui	75 V DC
Rated operating current Ie	200 mA
Rated operating voltage Ue DC	24 V
Rated short circuit current	100 A
Ready delay tv max.	50 ms
Residual current Ir max.	100 µA
Ripple max. (% of Ue)	20 %
Switching frequency	1000 Hz
Utilization category	DC -13
Voltage drop static max.	2 V

Environmental conditions

Ambient temperature	-25...70 °C
Contamination scale	3
EN 60068-2-27, Shock	Half-sinus, 30 gn, 11 ms
EN 60068-2-6, Vibration	55 Hz, amplitude 1 mm, 3x30 min
IP rating	IP67

Functional safety

MTTF (40 °C)	455 a
--------------	-------

Interface

Switching output	PNP normally open (NO)
------------------	------------------------

Material

Housing material	Brass, Chrome-plated
Material jacket	PUR
Material sensing surface	PBT

Mechanical data

Dimension	Ø 6.5 x 45 mm
Installation	quasi-flush
Mounting length	45.00 mm
Size	D6.5

Range/Distance

Assured operating distance Sa	2.4 mm
Hysteresis H max. (% of Sr)	10.0 %
Rated operating distance Sn	3 mm
Real switching distance sr	3 mm
Repeat accuracy max. (% of Sr)	5.0 %
Switching distance marking	■■■
Temperature drift max. (% of Sr)	10 %
Tolerance Sr	±10 %

Remarks

The sensor is functional again after the overload has been eliminated.
Quasi-flushed: See installation instructions for inductive sensors with extended range 825356.
EMC: For operating conditions with noise sources
External protection circuit is required. Document 825345.
For more information about MTTF and B10d see MTTF / B10d Certificate

Indication of the MTTF- / B10d value does not represent a binding composition and/or life expectancy assurance; these are simply experiential values with no warranty implications. These declared values also do not extend the expiration period for defect claims or affect it in any way.

Connector Drawings



Wiring Diagrams

