

Bulkhead Connectors
BCC M458-M458-5X-RM147-000
Order Code: BCC0LJE

BALLUFF

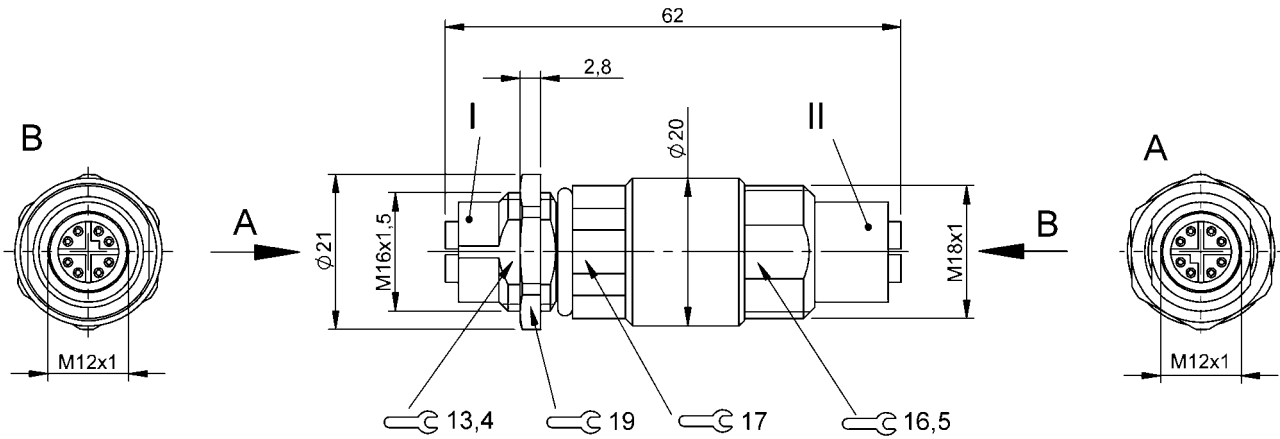

Basic features

Approval/Conformity	CE WEEE
---------------------	------------

Electrical connection

Connection 1	M12x1-Female, straight, 8-pin, X-coded
Connection 2	M12x1-Female, straight, 8-pin, X-coded
Connector 01, version	straight
Connector 02, version	straight
Number of pins	8/8

Electrical data

Operating voltage U_b	60 VDC / 50 VAC
Rated current (40 °C)	0.5 A

Remarks

Enclosure rating per IEC 60529 or 20653, only in screwed state with the associated mating piece.

Environmental conditions

Ambient temperature	-40...85 °C
IP rating	IP67/IP67

Material

Material contact carrier	PA/PA
Material contacts	Brass/Brass
Material grip	Nickel-plated brass Die-cast zinc/Nickel-plated brass Die-cast zinc

Mechanical data

Mounting part	M16x1.5
---------------	---------

Connector Drawings

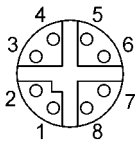

I, II

- PIN 1: white/orange
- PIN 2: orange
- PIN 3: white/green
- PIN 4: green
- PIN 5: white/brown
- PIN 6: brown
- PIN 7: white/blue
- PIN 8: blue

Wiring Diagrams

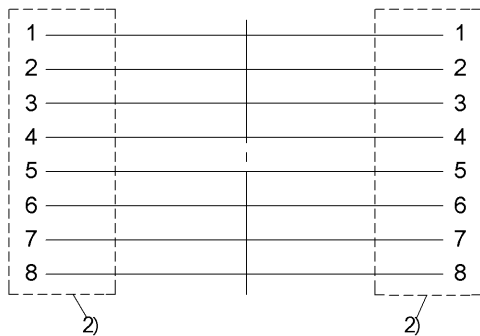

2) Shield on housing