

Capacitive Sensors
BCS M12TTI1-POM60G-EP02
Order Code: BCS00EF

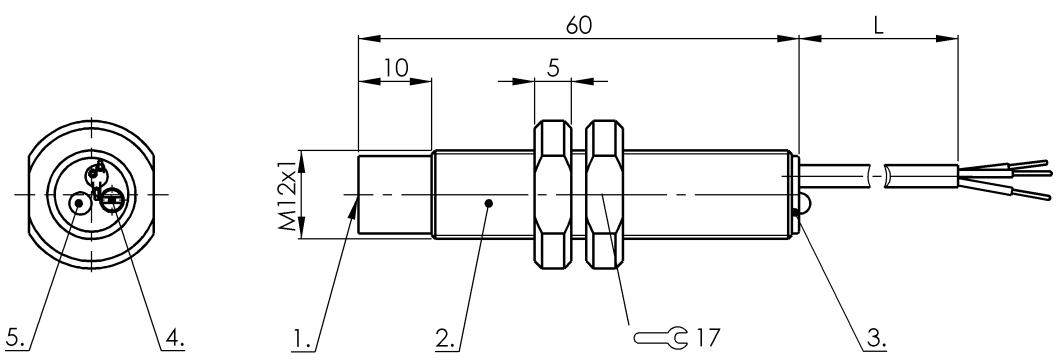

1) Sensing surface, 2) Housing, 3) Cover, 4) Potentiometer, 5) LED function indicator



Basic features

Approval/Conformity	CE UKCA cULus WEEE
Basic standard	IEC 60947-5-2
Scope of delivery	Nut (2x) Screwdriver Short guide
Sensitivity	Switching distance adjustable
Series	M12

Electrical data

No-load current I_0 max. at U_e	15 mA
Operating voltage U_b	12...35 VDC
Rated insulation voltage U_i	75 V DC
Rated operating current I_e	200 mA
Rated operating voltage U_e DC	24 V
Ripple max. (% of U_e)	10 %
Switching frequency	25 Hz
Utilization category	DC -13
Voltage drop static max.	0.8 V

Display/Operation

Function indicator	yes
--------------------	-----

Electrical connection

Cable diameter D	3.0 mm
Cable length L	2 m
Conductor cross-section	0.24 mm ²
Number of conductors	3
Polarity reversal protected	yes
Protection against device mix-ups	yes
Short-circuit protection	yes

Environmental conditions

Ambient temperature	-30...60 °C
Contamination scale	1
IP rating	IP65

Functional safety

MTTF (40 °C)	595 a
--------------	-------

Interface

Switching output	PNP normally closed (NC)
------------------	--------------------------

Material

Cover material	POM
Housing material	PTFE
Material jacket	PUR
Material sensing surface	PTFE

Mechanical data

Dimension	Ø 12 x 60 mm
Installation	non-flush
Size	M12x1
Thread (A)	M12x1
Tightening torque	0.5 Nm

Range/Distance

Hysteresis H max. (% of Sr)	15.0 %
Measuring range	1...6 mm
Rated operating distance Sn	6 mm
Repeat accuracy max. (% of Sr)	2.0 %
Temperature drift max. (% of Sr)	15 % [-5...55 °C]

Remarks

The potentiometer does not have a fixed stop, but can be turned endlessly without destroying anything.
If no change in the switching signal is detected, the potentiometer should be turned forwards or backwards until a signal change occurs at the output.
For more information about MTTF and B10d see MTTF / B10d Certificate

Indication of the MTTF- / B10d value does not represent a binding composition and/or life expectancy assurance; these are simply experiential values with no warranty implications. These declared values also do not extend the expiration period for defect claims or affect it in any way.

Wiring Diagrams

