

IP080175

Inductive sensors • pressure-proof

Sensor Inductive, pressure-proof, M8x1 45long, flush, Sn: 1.5, 10-30V diagnostic coverage, -25-80°C, PNP NO, M8 connector 3-pin, IP68, stainl. steel, 500bar

including Nut



Inductive proximity switches are contactless sensors. They detect all conductive metals, regardless of whether they are moving or not. The switching distance that the devices can achieve depends on the object material and its dimensions. The vibration-resistant sensors can be approached laterally or from the front. Inductive proximity switches are used for presence detection (e.g. goods carriers), positioning (e.g. oven flaps), counting (e.g. nuts / screws), speed detection (e.g. on gear wheels), on conveyor systems (e.g. hose feeds) or distance measurement (e.g. press-fit inspection) of metallic objects.

Electrical features

Display	LED display
Type of switching function	Normally open contact (NO)
Type of electrical connection	Connector M8
Type of switching output	PNP
Rated switching current	100mA
Readiness delay	20ms
Relative hysteresis	15%
Short-circuit protection	Yes
No-load current	10mA
Number of pins	3
Residual ripple	10%
Switching distance	1,5mm
Switching frequency	4000Hz
Voltage drop	2.5V
Reverse polarity protection	Yes
Operating voltage (DC)	10 - 30V

Mechanical features

Alignment of cable entry	axial
Design	Cylinder, screw-thread
Pressure resistance	500bar
Thread length	20mm
Thread pitch	1mm
Cable infeed	axial
Length	45mm
Maximum tightening torque	6Nm
Max. operating pressure	500bar
Max. peak pressure	500bar
Mechanical mounting condition for sensor	flush
Degree of protection (IP)	IP68
Active area material of sensor	Ceramics
Housing material	Stainless steel
Thread dimension	M8
Ambient temperature	-25 - 80°C

Other features

End position sensing, hydraulic cylinder	Yes
--	-----

Classification

ETIM 8

More

IPF Product Group	208 inductive sensors (pressure resistant)
packaging dimensions	120 x 100 x 20 mm
gross weight	11 g
Customs tariff number	85365019
WEEE number	40951076
Reach-compliant	Yes
RoHS-compliant	Yes
MTTF (40°C)	735 year(s)
MTTFd	1470 year(s)

Connection

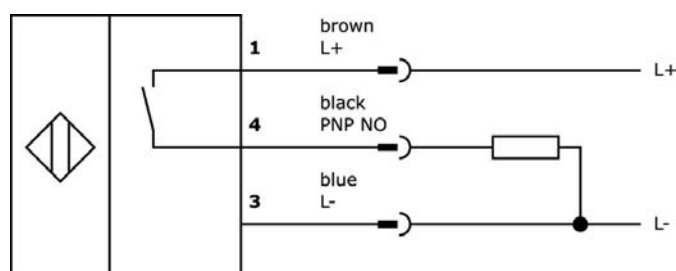

Dimensional drawing

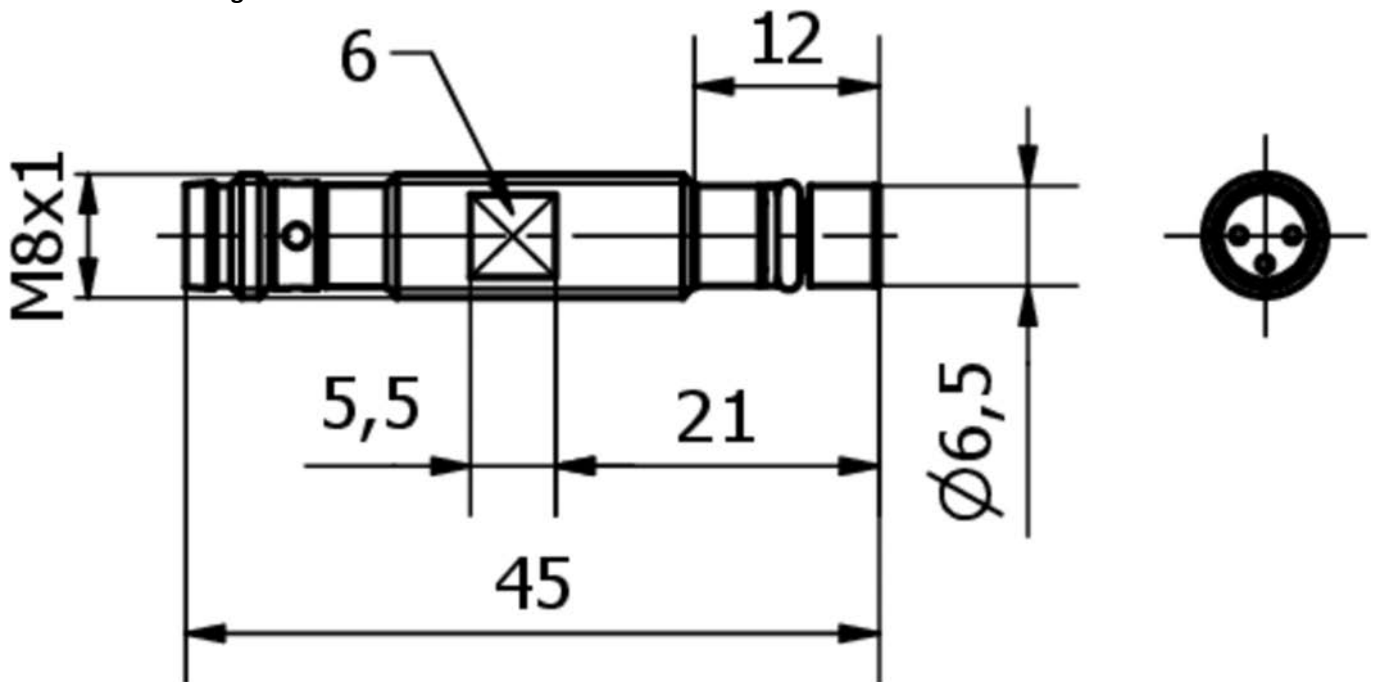

Installation



Mounting / installation may only be carried out by a qualified electrician!

Disposal



Safety warnings

Before initial operation, please make sure to follow all safety instructions that may be provided in the product information.

Never use these devices in applications where the safety of a person depends on their functionality.

For suitable connection and mounting accessories, please refer to our website www.ipf-electronic.com.