

DT243103

Pressure sensors • Pressure transmitter

Pressure transmitter, Ø24mm, 57 long, 0-40bar, 9-30V DC, G1/4 "A, 4-20mA, M12 plug connector 4-pin, IP67, stainless steel V4A



compact design
robust VA housing

Pressure sensors are suitable for measuring various media with high accuracy. They are available with switching output and/or analog output. By means of PC software the measured values can be recorded depending on the device type. These sensors are used in all areas, e.g. pneumatic and hydraulic applications.

Electrical features

Initial setting	0 - 40000 hPa
Response/decay time	3 ms
Type of analog output	4 - 20mA
Type of electrical connection	Connector M12
Short-circuit protection	Yes
Load resistance (current output)	0.5 kOhm
No-load current	25 mA
Measuring range pressure	0 - 40 bar
Measurement method	Relative
Number of pins	4
Relative linearity deviation	0.5 %
Relative repeat accuracy	0.2 %
Protection class	III
Temperature drift over entire measuring range	1.5 %
Reverse polarity protection	Yes
Operating voltage (DC)	9 - 30 V
ardSOCA_ElektrischerAnschluss	M12 4-pin plug connector
ardSOCA_Betriebsspannung	9-30VDC

Mechanical features

Type of process connection	G1/4 inch
Design	Cylinder plain
Bursting pressure	140 bar
Diameter	23.9 mm
Storage temperature	-30 - 85 °C
Length	56.3 mm
Max. operating pressure	100 bar
Medium temperature	-25 - 100 °C
Wrench size	22 mm
Degree of protection (IP)	IP67
Housing material	Stainless steel 1.4404
Seal material at process connection	Plastic (FKM)
Long-term drift per year	0.1 %
Ambient temperature	-25 - 80 °C
ardSOCA_Abmessungen	Ø23.9mm, 56.3mm long
ardTEME_WerkstoffDesProzessanschlusses	Stainless steel 1.4404
ardTEME_WerkstoffDerMesszelle	Ceramic

Other features

Suitable for	Fluid group 2
--------------	---------------

Classification

ETIM 8

More

IPF Product Group	361 pressure sensors (diverse)
packaging dimensions	105 x 43 x 43 mm
gross weight	85 g
Customs tariff number	90262020
WEEE number	40951076
Reach-compliant	Yes
RoHS-compliant	Yes
MTTF value	2236 year(s)

Connection

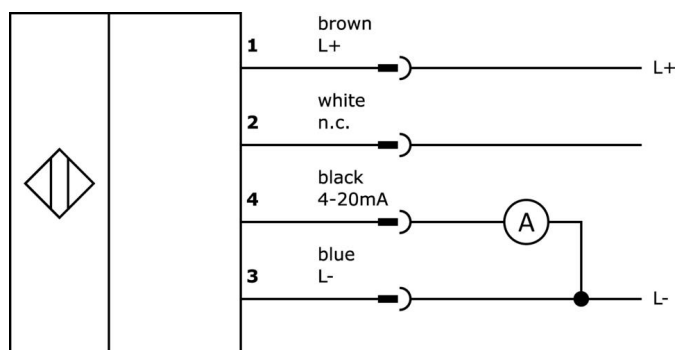

Dimensional drawing

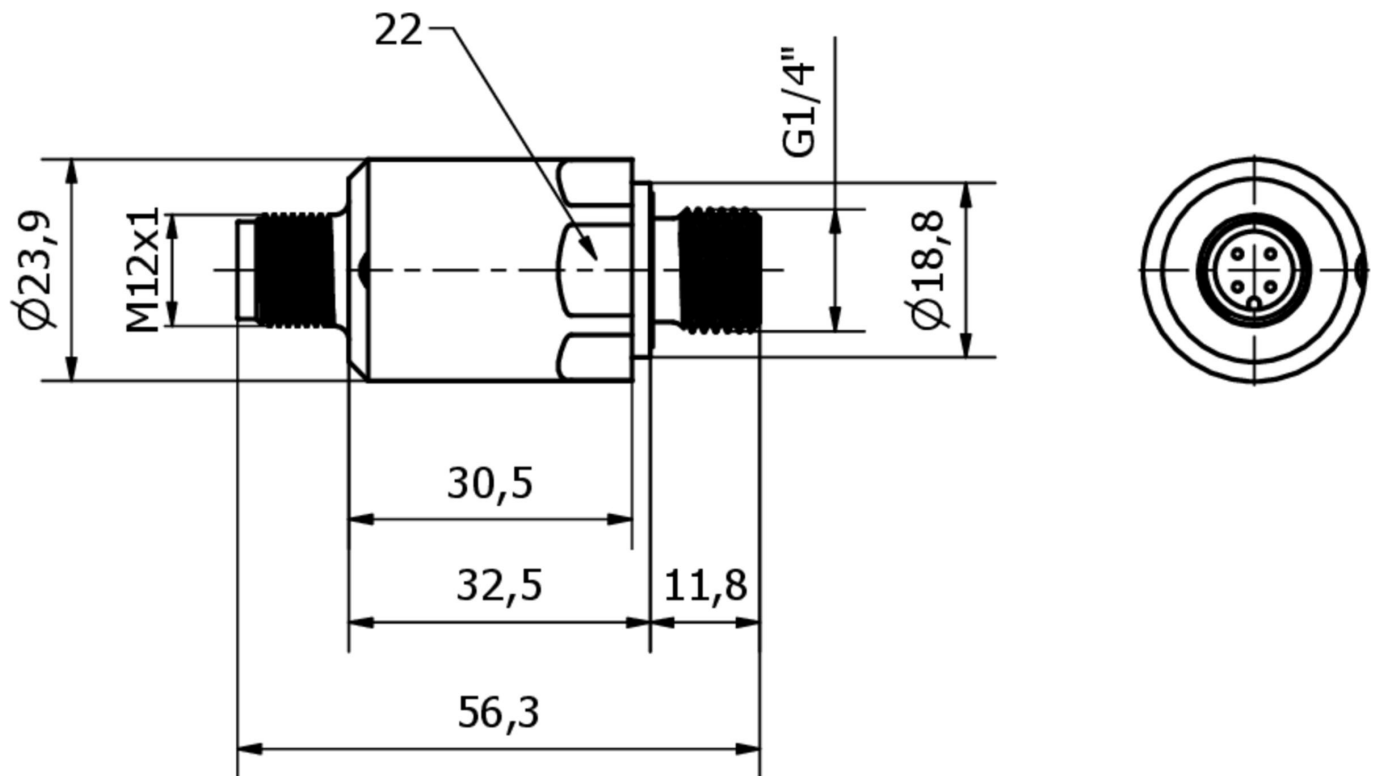

Extract accessories program

VK205321

Connection cable, 2m, M12
Female (socket) 4pin Angular, Free conductor end, 4x0.34mm², PUR (Polyurethane), Ø5.5mm, 250V, -25-90°C, IP67, Shielded, Suitable for trailing chain and torsion resistant, Oil and cooling lubricants, Welding area, Silicon...

VK205325

Connection cable, 2m, M12
Female (socket) 4pin Straight, Free conductor end, 4x0.34mm², PUR (Polyurethane), Ø5.5mm, 250V, -25-90°C, IP67, Shielded, Suitable for trailing chain and torsion resistant, Oil and cooling lubricants, Welding area, Silico...

VK003020

Cable socket, angular, self-assembly, screw connection, Ø3-6.5mm, 4A, 240V, -25-90°C, M12 socket 4-pin, IP67, PBT

VK003024

Cable socket, Straight, Suitable for self-assembly, Screw connection, Ø3-6.5mm, 4A, 240V, -25-90°C, M12 Female (socket) 4pin, IP67, PBT

AD000018

Accessories pressure, adapter, G1/2 - G1/4, 25lang, V4A

AD000017

Accessories pressure, adapter, G1/4, 26lang, V4A

AD000026

Accessories Throttle screw, M5x6mm, stainless steel 1.4404

You can find further accessories on our homepage

**Installation**

Mounting / installation may only be carried out by a qualified electrician!

**Disposal**

WEEE number according to § 6 para. 3
ElektroG: 40951076

Safety warnings

- / Before initial operation, please make sure to follow all safety instructions that may be provided in the product information.
- / Never use these devices in applications where the safety of a person depends on their functionality.