

MZ07A210

Magnetic field sensors • Sensors for T-slot

Sensor Magnetic, cylinder, 6.2mm T-slot, 6x32x5mm, 8.2V DC, NAMUR, cable tail 2m PVC, IP67, plastic, ATEX, LED, installation from above, position of sensor surface edge area



For many tasks in the field of automation technology, it is necessary to recognize the motional processes in pneumatic and hydraulic cylinders and to detect the position of the piston with precision. For this, magnetic cylinder sensors are used.

Electrical features

Display	LED display
Type of electrical connection	Cable
Type of switching output	NAMUR
Rated switching current	2100 mA
Absolute hysteresis	1 mm
Short-circuit protection	No
No-load current	1.2 mA
Switching frequency	1000 Hz
Sensor surface (active)	Border area / edge area
Reverse polarity protection	No
Absolute repeat accuracy	0.1 mm
Operating voltage (DC)	8,2 V

Mechanical features

Number of cores	2
Conductor cross-section	0.14 mm ²
Design	Cuboid
Width	5 mm
Height	6 mm
Cable length	2 m
Sensor surface position	Border area of the device
Length	32 mm
Mounting access, cylinder groove	From the top
Degree of protection (IP)	IP67
Housing material	Plastic
Material of cable sheath	Plastic (PVC)
Ambient temperature	-25 - 70 °C
Line diameter	3 mm

Other features

Explosion safety category for gas	ATEX gas-ex-protection, Cat. 1G
Explosion safety category for dust	ATEX dust-ex-protection, Cat. 1D
Suitable for	6.2mm T-slot
SIL in acc. with IEC 61508	2
Cylinder version	With T-groove

Classification

ETIM 8	EC002544 Magnetic proximity switch
--------	------------------------------------

More

IPF Product Group	223 pneumatic cylinder sensors (diverse)
packaging dimensions	149 x 124 x 28 mm
gross weight	80 g
Customs tariff number	85365019
WEEE number	40951076
ATEX-compliant	Yes
OzDS-compliant	Yes
POP-compliant	Yes
Reach-compliant	Yes
RoHS-compliant	Yes

Connection

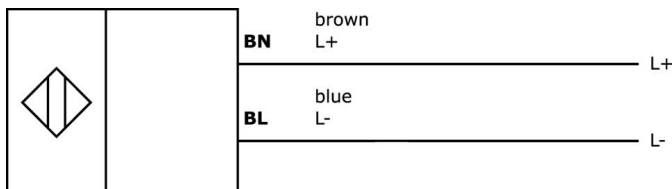

Dimensional drawing

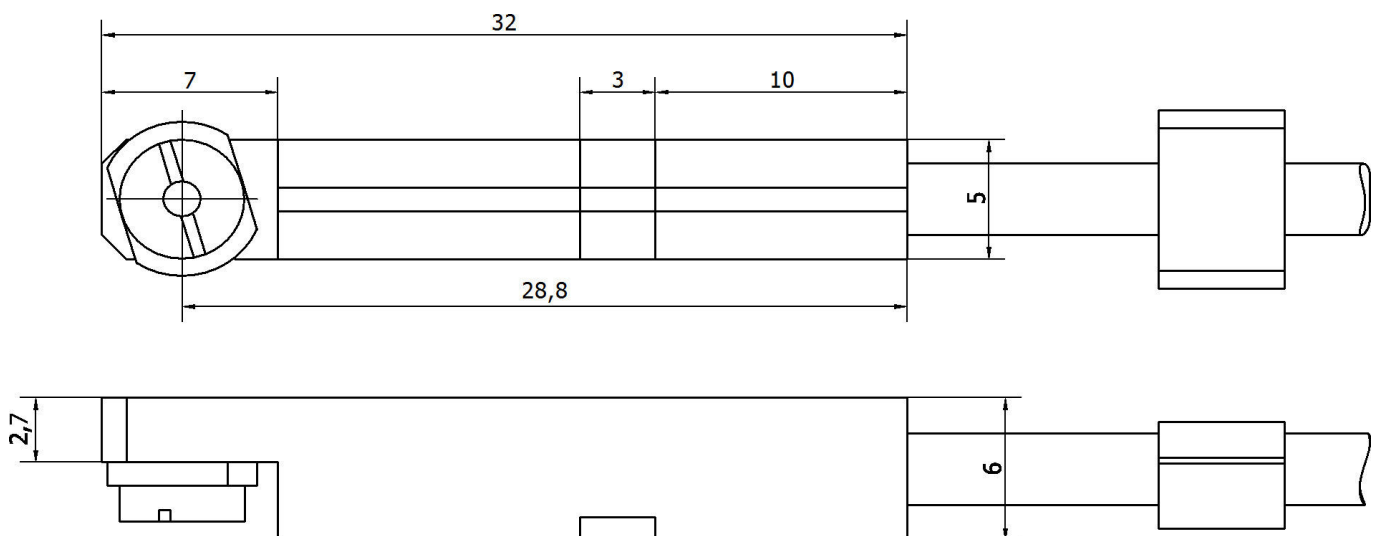

Extract accessories program

AM000076



accessories magnetic, clamp, 4x6,
2x6,2mm, aluminum

NG530002



DC power supply, single-phase,
99x114x22mm, 24V, 0.1A,
Number of relay outputs 2, 100-
264V AC 50Hz, 100-264V AC 60Hz,
Screw connection, IP20, Plastic,
Stabilized, Output voltage, pulsed

AY000141



Plastic sheath, Ø17mm, Inner
diameter 10mm, -40-250°C, Glass
fiber with silicone rubber, Short-
term resistance to weld spatter
1200°C, Tensile strength 400N,
Flexible, Flame retardant, yard
good

AY000154



Tool, Screwdriver set, Internal
hexagon 0.7mm, Internal hexagon
0.9mm, Internal hexagon 1.3mm,
Internal hexagon 1.5mm, Internal
hexagon 2mm, Slot 1.5mm, Slot
2mm, Slot 2.5mm, Chromium steel

AM98E153



accessories magnetic, Installation
tape, 259x9,5mm, Span 35-68mm,
For sensor MZ07, Stainless steel

AM000087



accessories magnetic, Cable clip,
Plastic

VY000004



DC power supply, sensor tester,
120x26x72mm, 18V, 0.04A, Spring
clamp connection 4pin, IP20,
Plastic

AM000037



accessories magnetic, Mounting
clip, 18x19x19mm, span 8.3-9.
4mm, Plastic, For sensor MZ07, for
Cylinder, 8round

AM000038



accessories magnetic, Mounting
clip, 20x21x19mm, span 10.2-11.
95mm, Plastic, For sensor MZ07,
for Cylinder, 10round

You can find further accessories on our homepage



Installation

Mounting / installation may only be carried
out by a qualified electrician!



Disposal

WEEE number according to § 6 para. 3
ElektroG: 40951076

Safety warnings

/ Before initial operation, please make sure to follow all safety instructions that may be provided in the product information.

/ Never use these devices in applications where the safety of a person depends on their functionality.