

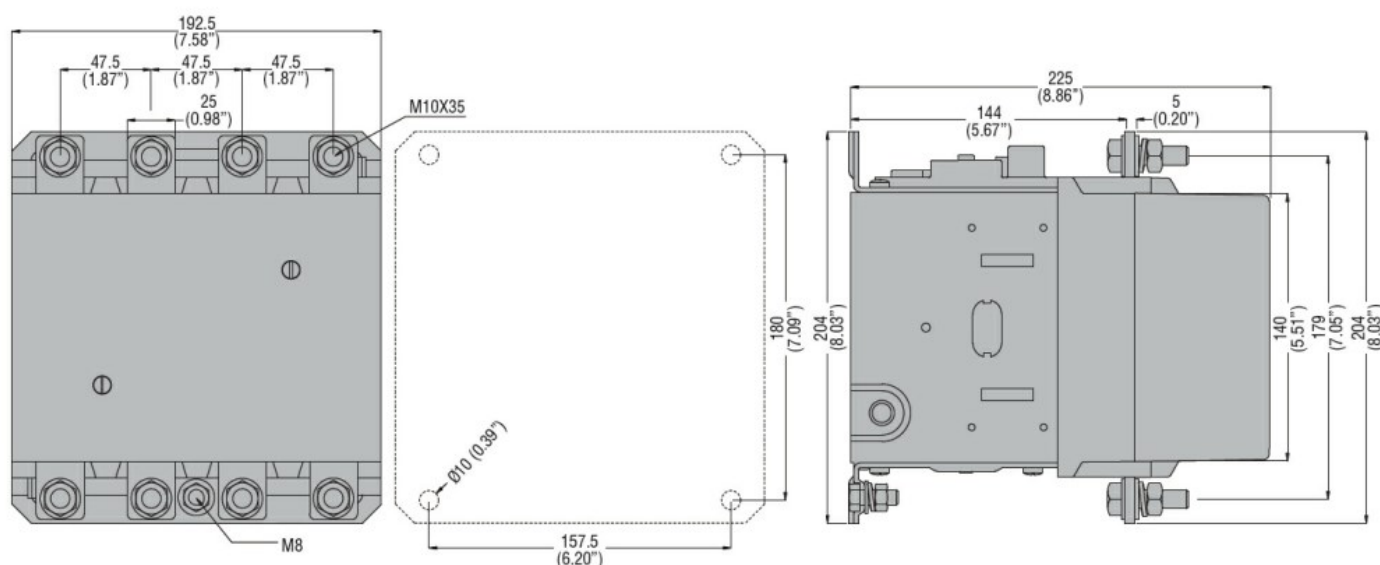

Contact characteristics

Number of poles	Nr.	4
Operational current Ie	AC-4 (400V)	A 115

Dimensions



Wiring diagrams

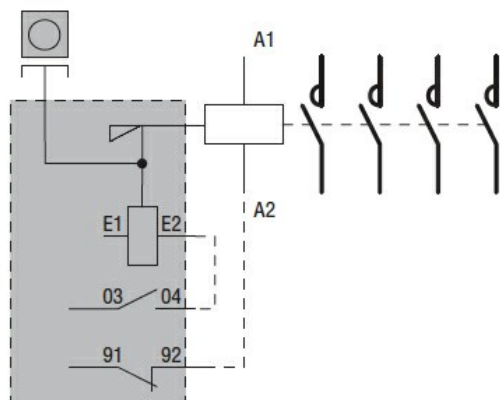

Certifications and compliance

Compliance

CSA C22.2 n° 60947-1
CSA C22.2 n° 60947-4-1
IEC/EN 60947-1
IEC/EN 60947-4-1
UL 60947-1
UL 60947-4-1

Certificates

CCC

cULus

EAC