

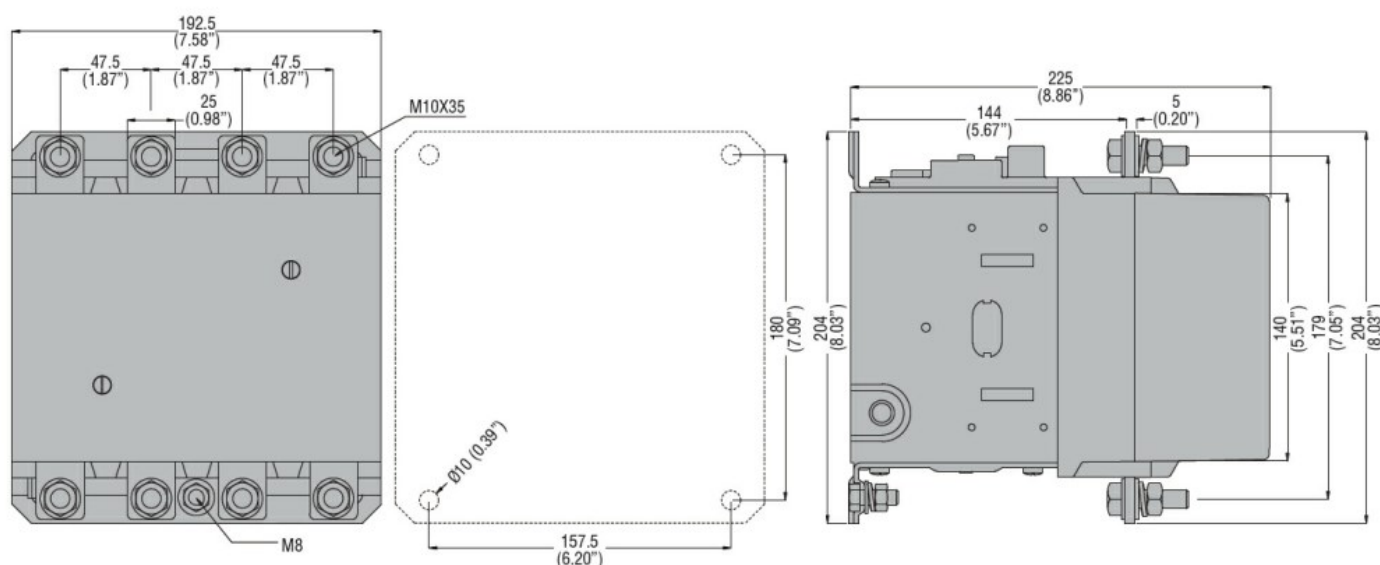

Contact characteristics

Number of poles	Nr.	4
Operational current Ie	AC-4 (400V)	A 200

Dimensions



Wiring diagrams

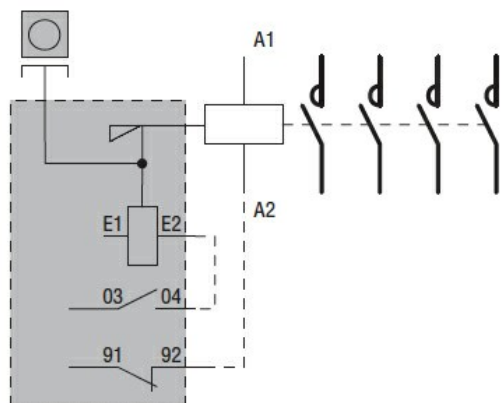

Certifications and compliance

Compliance	CSA C22.2 n° 60947-1
	CSA C22.2 n° 60947-4-1
	IEC/EN 60947-1
	IEC/EN 60947-4-1
	UL 60947-1
	UL 60947-4-1
Certificates	CCC

cULus

EAC