



Top push rod  
plunger  
KCA

Product designation

Product type designation

### General characteristics

Material

Housing

Rod

Polymer  
thermoplastic  
Aluminium-zinc  
alloy

### Contact characteristics

Type of contact		1NO+1NC Snap action
Thermal current Ith	A	10
IEC/EN 60947-5-1 designation		A600 Q300
Rated insulation voltage Ui	V	690
Rated impulse withstand voltage Uimp	kV	6
Insulation class		II
Short-circuit protection with fuse	Class/A	10 gG/SC QUICK FUSE
Switching speed	min max	m/s 0.5 m/s 1.5
IEC Conventional free air thermal current Ith	A	10
Resistance per pole (average value)	m?	<10

### Mechanical features

Operating head fixing		Locking bayonet insert
Operating torque	N lb	5 1.1
Tightening torque (Max)		
Switch fixing	Nm lbin	2.5 22.1
Contact terminals	Nm lbin	0.8 7
Body lid screw fixing	Nm lbin	0.8 7
Conductor section		
AWG/Kcmil	min max	16 14
IEC	min mm <sup>2</sup>	1or 2

	max	mm <sup>2</sup>	2.5
Cable connection			Self-releasing screw terminal
Cable entry			M20 on the sides
<b>Operations</b>			
Mechanical life	cycles		<10000000
Mechanical operation	cycles/h		3600
<b>Ambient conditions</b>			
Temperature			
Operating temperature	min	°C	-25
	max	°C	+70
Storage temperature	min	°C	-40
	max	°C	+70
<b>Resistance &amp; Protection</b>			
IP degree	Terminals		IP20
	Body housing		IP65
Pollution degree			3
<b>Dimensions</b>			

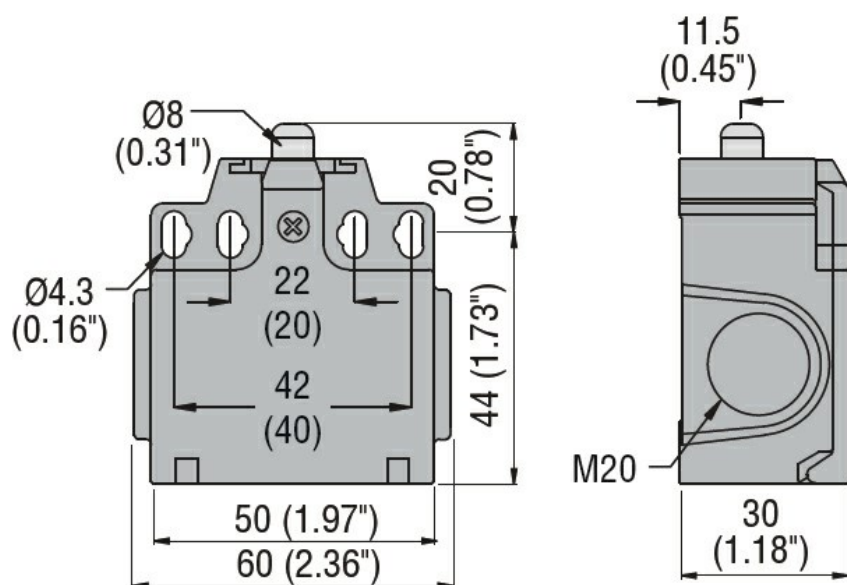

## Wiring diagrams

## Snap action

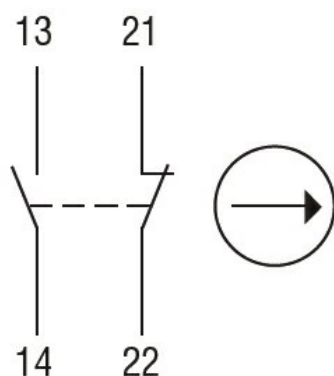

**1NO + 1NC**

### Certifications and compliance

#### Compliance

CSA C22.2 n° 14

EN 50047

IEC/EN 60204-1

IEC/EN 60947-1

IEC/EN 60947-5-1

UL508

#### Certificates

CCC

cULus

EAC

### ETIM classification

ETIM 8.0

EC000030 - End  
switch