



Top push rod -
metal and high
rod plunger
KSA2

Product designation

Product type designation

General characteristics

Material

Housing

Polymer
thermoplastic

Contact characteristics

Type of contact			1NO/NC
Thermal current Ith	A		15
IEC/EN 60947-5-1 designation			A600 P300
Rated insulation voltage Ui	V		250
Switching speed	min max	m/s m/s	0.01 1

Operating speed

	min max	m/s m/s	0.05 1
IEC Conventional free air thermal current Ith	A		15
Resistance per pole (average value)	m?		<15
Conductivity			10mA 5V

Mechanical features

Terminals type			Faston
Operating head fixing			Fixed
Operating torque		N ozin g	2.5 9 34
Weight		g	34

Operations

Mechanical life	cycles		20000000
Electrical life	cycles		500000
Mechanical operation	cycles/h		240

Ambient conditions

Temperature

Operating temperature

min	°C	-25
max	°C	+70

Storage temperature

min	°C	-40
max	°C	+70

Resistance & Protection

IP degree

Body housing

IP00 or IP20 with
terminal shroud

Pollution degree

3

Dimensions

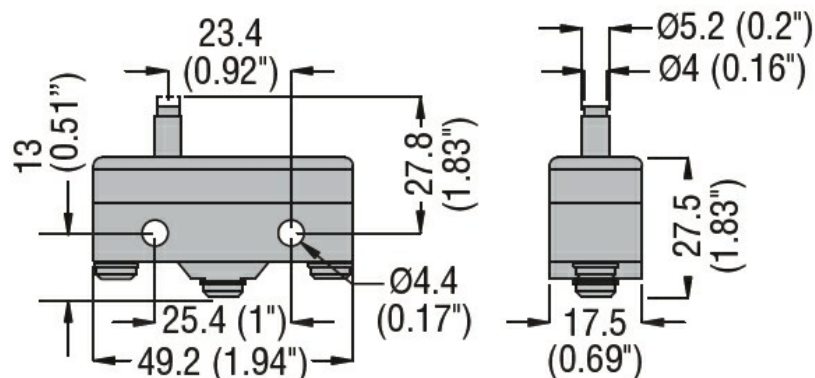

Wiring diagrams

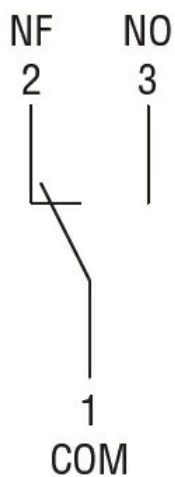

Certifications and compliance

Compliance

CSA C22.2 n° 14.

IEC/EN 60947-1

IEC/EN 60947-5-1

IEC/EN 61058-1

UL508

Certificates

cURus

EAC

ETIM classification

ETIM 8.0

EC000030 - End
switch