



RZC1-04ZUS-KUAS02

RZC1

CYLINDER SENSORS

SICK
Sensor Intelligence.



Ordering information

Type	part no.
RZC1-04ZUS-KUAS02	1070035

Other models and accessories → www.sick.com/RZC1



Detailed technical data

Features

Cylinder type	C-slot
Cylinder types with adapter	SMC rail CDQ2 SMC rail ECDQ2
Housing length	26.3 mm
Switching output	Reed
Switching frequency	500 Hz
Output function	NO
Electrical wiring	AC/DC 2-wire
Enclosure rating	IP67 ¹⁾

¹⁾ According to EN 60529 (IP 67 / IP 68).

Mechanics/electronics

Supply voltage	5 V AC/DC ... 30 V AC/DC
Power consumption	5 mA, without load
Voltage drop	< 3.2 V
Continuous current I_a	≤ 50 mA
Switching capacity	≤ 6 W
Protection class	II ¹⁾ 2)
Overrun distance, typ.	7 mm
Reproducibility	≤ 0.1 mT ³⁾
Status indicator LED	Yes
Teach-in	No
Ambient operating temperature	-30 °C ... +80 °C

¹⁾ The sensor may only be used when mounted as a complete unit in the slot.

²⁾ Overvoltage category II.

³⁾ Supply voltage U_B and constant ambient temperature T_a.

Shock and vibration resistance	30 g, 11 ms / 10 ... 55 Hz, 1 mm
EMC	According to EN 60947-5-2
Connection type	Cable, 2-wire, stripped, 3 m
Connection type Detail	
Conductor cross section	0.09 mm ²
Cable diameter	Ø 2.2 mm
Bending radius	With fixed installation > 2 x cable diameter
	For flexible use > 5 x cable diameter
Cable outlet	Axial
Material	
Housing	Plastic, PA, strengthened
Cable	PUR

¹⁾ The sensor may only be used when mounted as a complete unit in the slot.

²⁾ Overvoltage category II.

³⁾ Supply voltage U_B and constant ambient temperature T_a .

Certificates

EU declaration of conformity	✓
UK declaration of conformity	✓
ACMA declaration of conformity	✓
Moroccan declaration of conformity	✓
China-RoHS	✓
cULus certificate	✓

Classifications

ECLASS 5.0	27270104
ECLASS 5.1.4	27270104
ECLASS 6.0	27270104
ECLASS 6.2	27270104
ECLASS 7.0	27270104
ECLASS 8.0	27270104
ECLASS 8.1	27270104
ECLASS 9.0	27270104
ECLASS 10.0	27270104
ECLASS 11.0	27270104
ECLASS 12.0	27274301
ETIM 5.0	EC002544
ETIM 6.0	EC002544
ETIM 7.0	EC002544
ETIM 8.0	EC002544
UNSPSC 16.0901	39122230

Installation note

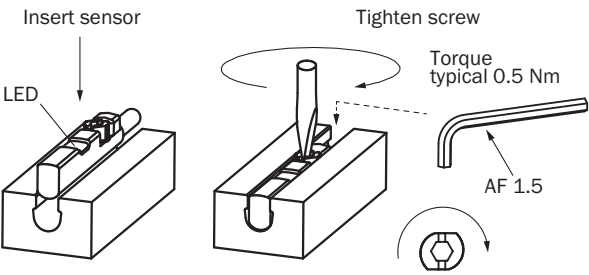

Connection diagram Cd-037

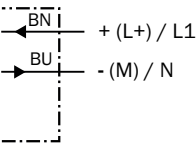

Dimensional drawing Cable

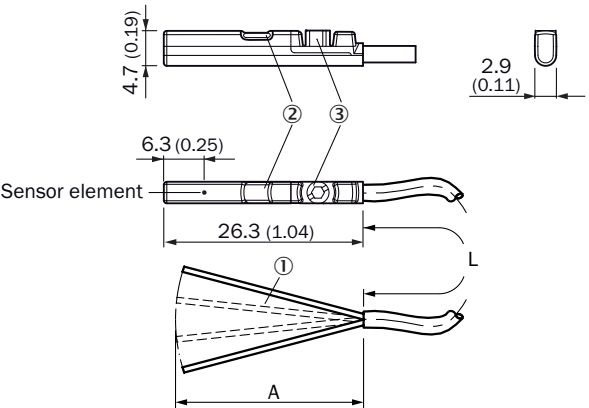

Dimensions in mm (inch)

- ① Connection
- ② Display LED
- ③ Fixing screw SW 1.5

		L	A	
1059746	RZC1-04ZRS-KU0	2 m	31.5	3
1059750	RZC1-04ZUS-KU0	2 m	31.5	2
1065397	RZC1-04ZUS-KU0S01	2 m	31.5	2
1070035	RZC1-04ZUS-KUAS02	3 m	31.5	2
1059749	RZC1-04ZRS-KUB	5 m	31.5	3
1073286	RZC1-04ZUS-KUBS03	5 m	31.5	2

Recommended accessories

Other models and accessories → www.sick.com/RZC1

	Brief description	Type	part no.
Mounting systems			
	<ul style="list-style-type: none">• Description: Mounting bracket on round body cylinder with piston diameter of 1 mm ... 130 mm, ambient temperature min -30 °C max 80 °C• Material: Stainless steel, Aluminum• Details: Stainless steel, Aluminum• Packing unit: 1 piece• Suitable for: C-slot	BEF-KHZ-RC1-130	2077686
	<ul style="list-style-type: none">• Description: Mounting bracket on round body cylinder with piston diameter of 12 mm, ambient temperature min 0 °C max 50 °C• Material: Plastic, Aluminum• Details: Plastic, Aluminum• Packing unit: 1 piece• Suitable for: C-slot	BEF-KHZ-RC-12	2077673
	<ul style="list-style-type: none">• Description: Mounting bracket on round body cylinder with piston diameter of 1 mm ... 25 mm, ambient temperature min -30 °C max 80 °C• Material: Stainless steel, Aluminum• Details: Stainless steel, Aluminum• Packing unit: 1 piece• Suitable for: C-slot	BEF-KHZ-RC1-25	2077685
	<ul style="list-style-type: none">• Description: Mounting bracket on round body cylinder with piston diameter of 16 mm, ambient temperature min 0 °C max 50 °C• Material: Plastic, Aluminum• Details: Plastic, Aluminum• Packing unit: 1 piece• Suitable for: C-slot	BEF-KHZ-RC-16	2077672
	<ul style="list-style-type: none">• Description: Mounting bracket on round body cylinder with piston diameter of 20 mm, ambient temperature min 0 °C max 50 °C• Material: Plastic, Aluminum• Details: Plastic, Aluminum• Packing unit: 1 piece• Suitable for: C-slot	BEF-KHZ-RC-20	2077671
	<ul style="list-style-type: none">• Description: Mounting bracket on round body cylinder with piston diameter of 25 mm, ambient temperature min 0 °C max 50 °C• Material: Plastic, Aluminum• Details: Plastic, Aluminum• Packing unit: 1 piece• Suitable for: C-slot	BEF-KHZ-RC-25	2077670
	<ul style="list-style-type: none">• Description: Mounting bracket on round body cylinder with piston diameter of 32 mm, ambient temperature min 0 °C max 50 °C• Material: Plastic, Aluminum• Details: Plastic, Aluminum• Packing unit: 1 piece• Suitable for: C-slot	BEF-KHZ-RC-32	2077669
	<ul style="list-style-type: none">• Description: Mounting bracket on round body cylinder with piston diameter of 40 mm, ambient temperature min 0 °C max 50 °C• Material: Plastic, Aluminum• Details: Plastic, Aluminum• Packing unit: 1 piece• Suitable for: C-slot	BEF-KHZ-RC-40	2077668
	<ul style="list-style-type: none">• Description: Mounting bracket on round body cylinder with piston diameter of 50 mm, ambient temperature min 0 °C max 50 °C• Material: Plastic, Aluminum• Details: Plastic, Aluminum• Packing unit: 1 piece• Suitable for: C-slot	BEF-KHZ-RC-50	2077667
	<ul style="list-style-type: none">• Description: Mounting bracket on round body cylinder with piston diameter of 63 mm, ambient temperature min 0 °C max 50 °C• Material: Plastic, Aluminum• Details: Plastic, Aluminum• Packing unit: 1 piece• Suitable for: C-slot	BEF-KHZ-RC-63	2077666
	<ul style="list-style-type: none">• Description: Mounting bracket for integrated profile cylinder/tie-rod cylinder• Material: Zinc diecast• Details: Zinc diecast• Items supplied: Mounting hardware included	BEF-KHZ-PC1	2076170

SICK AT A GLANCE

SICK is one of the leading manufacturers of intelligent sensors and sensor solutions for industrial applications. A unique range of products and services creates the perfect basis for controlling processes securely and efficiently, protecting individuals from accidents and preventing damage to the environment.

We have extensive experience in a wide range of industries and understand their processes and requirements. With intelligent sensors, we can deliver exactly what our customers need. In application centers in Europe, Asia and North America, system solutions are tested and optimized in accordance with customer specifications. All this makes us a reliable supplier and development partner.

Comprehensive services complete our offering: SICK LifeTime Services provide support throughout the machine life cycle and ensure safety and productivity.

For us, that is “Sensor Intelligence.”

WORLDWIDE PRESENCE:

Contacts and other locations –www.sick.com