

# Plastic Fiber-Optic Cable

## Through-Beam Mode

# K11

Part Number



- Especially suitable in applications where only minimal space is available
- Fiber-optic cable can be cut to length by the cutting tool

### Technical Data

#### Optical Data

Fiber Core Diameter	0,5 mm
Fiber Core	PMMA
Fiber	Step Index
Fiber Distribution	parallel arrangement
Range with Sensor Type	160 mm
Range with LA29	2500 mm
Opening Angle	55 °

#### Mechanical Data

Temperature Range	-40...85 °C
Bending Radius	15 mm
Fiber-Optic Length	2 m
Jacket Material	PE (black)
Material End Sleeve	Stainless Steel
Jacket Diameter	1 mm
Light Emission	straight

Suitable Mounting Technology No.

310

### Complementary Products

Lens LA29

Plastic fiber-optic cables are very flexible and suitable for use in confined spaces. The fiber optics are supplied in 2 m lengths. Special lengths of up to 50 m are possible. Users can shorten the fiber optics using the Z0015 cutting tool.

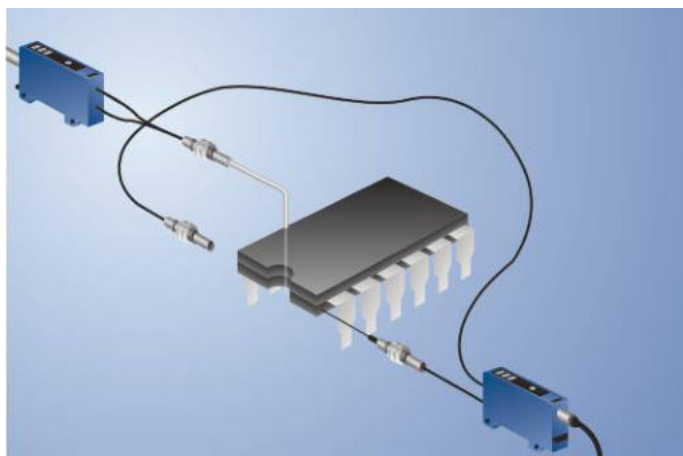

**K11**

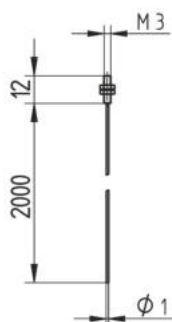

All dimensions in mm (1 mm = 0.03937 Inch)

