

S2FP005

Part Number



- Continuously monitored locking force of 1150 N
- Escape release
- Performance Level: Cat. 4 PL e
- Power to unlock principle

The electromechanical guard locking device is distinguished by a high, continuously monitored locking force of 1150 N. As a result, only one guard locking device is required in order to fulfill a safety level of category 4 PL e (EN ISO 13849-1). The safety level, as well as reaction time and risk time, remain unchanged when connected in series. Extensive diagnosis functions enhance system availability and simplify installation and maintenance. The unique star handle operating concept is especially well-suited for rotary and sliding doors. Thanks to RFID encoding and an actuator with teach-in function, the guard locking device demonstrates high levels of protection against manipulation.

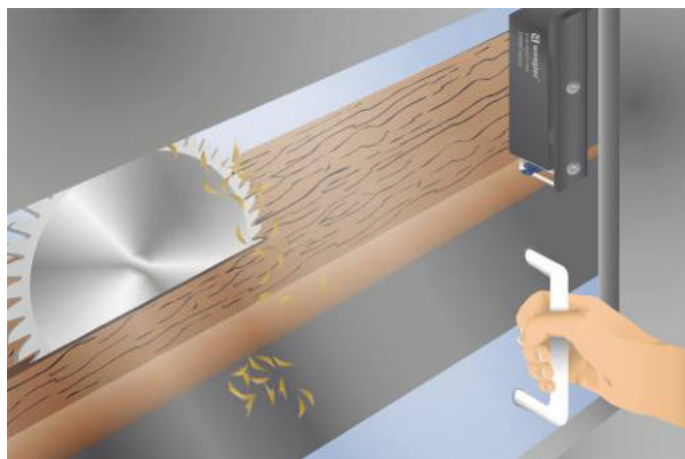

Technical Data

Electrical Data

Sensor Type	Locking unit
Supply Voltage	20,4...26,4 V DC
Response Time	≤ 100 ms
Risk time	≤ 200 ms
Temperature Range	0...60 °C
Storage temperature	-10...90 °C
Safety Output	OSSD
No. Safety Outputs (OSSDs)	2
PNP Safety Output/Switching Current	250 mA
Number of Signal Outputs	1
PNP signal output switching current	50 mA
Short Circuit Protection	yes
Protection Class	III

Mechanical Data

Housing Material	Plastic
Degree of Protection	IP66/IP67/IP69
Connection	M12 × 1; 8-pin
Latching Force, typical	25 / 50 N

Safety-relevant Data

Operating principle	RFID
Coding	Individual, teachable
Performance Level (EN ISO 13849-1)	Cat. 4 PL e *
PFHD	5,20 × E-10 1/h *
Safety Integrity Level (EN 61508)	SIL3*
Safety Integrity Level (EN 62061)	SILCL3*
PDDb (EN 60947-5-3)	yes
Locking Device	Power to unlock principle
Locking Force F (Zh)	1150 N

Function

Series Connection	yes
Monitored lock	yes
Mechanical Detent Mechanism	yes
Detent Mechanism	yes
Auxiliary release	yes
Emergency release	yes

Applicable actuator	S2FP200
Connection Diagram No.	P03
Suitable Connection Equipment No.	89
Suitable Mounting Technology No.	850

* For locking function

Complementary Products

Safety Relay SR4B3B01S, SR4D3B01S
Software

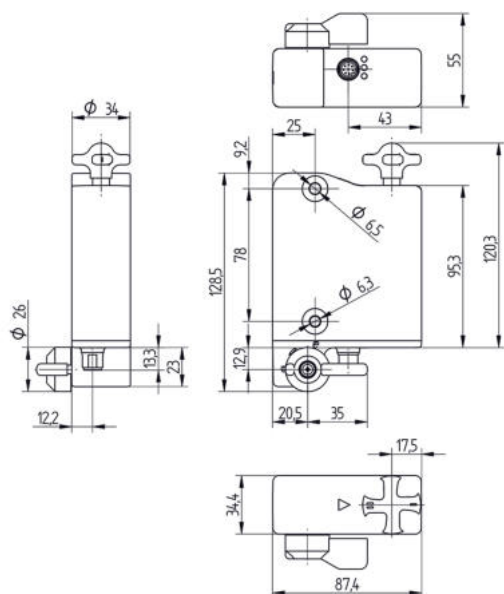

All dimensions in mm (1 mm = 0.03937 Inch)

P03

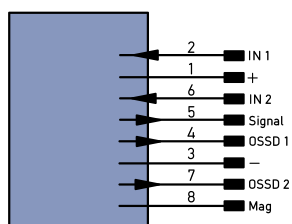

Legend

+	Supply Voltage +	PT	Platinum measuring resistor
-	Supply Voltage 0 V	nc	not connected
~	Supply Voltage (AC Voltage)	U	Test Input
A	Switching Output (NO)	U	Test Input inverted
Ā	Switching Output (NC)	W	Trigger Input
V	Contamination/Error Output (NO)	W-	Ground for the Trigger Input
Ṽ	Contamination/Error Output (NC)	O	Analog Output
E	Input (analog or digital)	O-	Ground for the Analog Output
T	Teach Input	BZ	Block Discharge
Z	Time Delay (activation)	AWV	Valve Output
S	Shielding	a	Valve Control Output +
RxD	Interface Receive Path	b	Valve Control Output 0 V
TxD	Interface Send Path	SY	Synchronization
RDY	Ready	SY-	Ground for the Synchronization
GND	Ground	E+	Receiver-Line
CL	Clock	S+	Emitter-Line
E/A	Output/Input programmable	±	Grounding
IO-Link	IO-Link	SnR	Switching Distance Reduction
PoE	Power over Ethernet	Rx+/-	Ethernet Receive Path
IN	Safety Input	Tx+/-	Ethernet Send Path
OSSD	Safety Output	Bus	Interfaces-Bus A(+)/B(-)
Signal	Signal Output	La	Emitted Light disengageable
BI-D+/-	Ethernet Gigabit bidirect. data line (A-D)	Mag	Magnet activation
EN0-PS422	Encoder 0-pulse 0-0 (TTL)	RES	Input confirmation
		EDM	Contacting Monitoring

EN0-PS422	Encoder A/Ā (TTL)
EN0-PS422	Encoder B/B̄ (TTL)
ENa	Encoder A
ENb	Encoder B
AMIN	Digital output MIN
AMAX	Digital output MAX
AOK	Digital output OK
SY in	Synchronization In
SY OUT	Synchronization OUT
OLt	Brightness output
M	Maintenance
rsv	reserved
Wire Colors according to IEC 60757	
BK	Black
BN	Brown
RD	Red
OG	Orange
YE	Yellow
GN	Green
BU	Blue
VT	Violet
GY	Grey
WH	White
PK	Pink
GNYE	Green/Yellow

