

# Mounting Console with Fixed Limit Stop for M12 × 1; Semi-Flush Mounting

## Z12M002

Part Number



### Technical Data

#### Mechanical Data

Material	Stainless Steel; Plastic
Threaded sleeve tightening torque	max. 3 Nm
Clamp retainer tightening torque	1,5 Nm
Packaging unit	1 Piece
Mounting Number	172

- For M12 × 1, semi-flush
- Integrated, fixed limit stop for precise sensor positioning
- No reduction of the switching distance
- Time savings thanks to easy installation

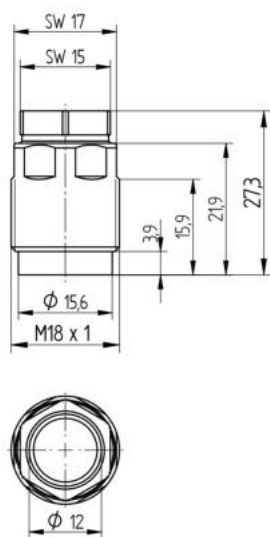

All dimensions in mm (1 mm = 0.03937 Inch)

