

Adapter

Dairy pipe fitting for G1/2" CIP

ZH7C006

Part Number

Technical Data

Mechanical Data

Material	Stainless steel 1.4404
Connection	G 1/2" CIP to DN25 dairy pipe
Packaging unit	1 Piece
Mounting Number	906



This dairy pipe fitting is suitable for the G1/2" CIP process connection for pipe joints in accordance with DIN32676.

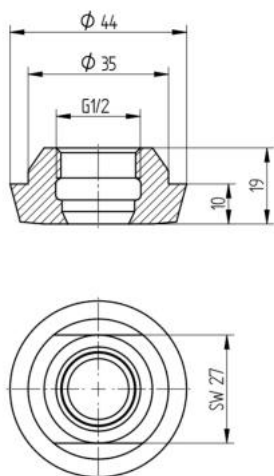

All dimensions in mm (1 mm = 0.03937 Inch)