

pressure switch XMLB 330 mbar - adjustable
scale 2 thresholds - 1 C/O



Main

| | |
|---|---|
| Range of product | Telemecanique Pressure sensors XM |
| Product or component type | Electromechanical pressure sensor |
| Pressure sensor type | Electromechanical pressure sensor |
| Device short name | XMLB |
| Pressure rating | 0.35 bar |
| Controlled fluid | Air (0...160 °C) Hydraulic oil (0...160 °C) |
| Fluid connection type | G 1/4 (female) conforming to ISO 228 |
| Electrical connection | Screw-clamps terminals, 1 x 0.5...2 x 2.5 mm² |
| AWG gauge | AWG 20...AWG 14 |
| Cable entry | Cable gland 9...13 mm |
| Contacts type and composition | 1 C/O |
| Product specific application | 30 bar overpressure |
| Pressure switch type of operation | Regulation between 2 thresholds |
| Electrical circuit type | Control circuit |
| Scale type | Adjustable differential |
| Local display | With |
| Adjustable range of switching point on rising pressure | 0.042...0.33 bar |
| Adjustable range of switching point on falling pressure | 0.009...0.272 bar |
| Possible differential maximum at high setting | 0.25 bar |
| Maximum permissible accidental pressure | 37.5 bar |
| Destruction pressure | 67.5 bar |
| Pressure actuator | Diaphragm |
| Materials in contact with fluid | 304L stainless steel FPM, FKM Steel |
| Enclosure material | Zinc alloy |
| [In] rated current | 3 A, B300, AC-15 (Ue = 120 V) conforming to IEC 60947-5-1 1.5 A, B300, AC-15 (Ue = 240 V) conforming to IEC 60947-5-1 0.1 A, R300, DC-13 (Ue = 250 V) conforming to IEC 60947-5-1 |

Complementary

| | |
|---|--------------------------------|
| Possible differential minimum at low setting | 0.033 bar (- 8 mbar, + 3 mbar) |
| Possible differential minimum at high setting | 0.058 bar (+/- 8 mbar) |
| Maximum permissible pressure - per cycle | 30 bar |
| Terminal block type | 4 terminals |
| Maximum operating rate | 120 cyc/mn |
| Repeat accuracy | 2 % |

| | |
|--|--|
| [Ui] rated insulation voltage | 300 V conforming to UL 508 500 V conforming to IEC 60947-1 300 V conforming to CSA C22.2 No 14 |
| [Uimp] rated impulse withstand voltage | 6 kV conforming to IEC 60947-1 |
| Auxiliary contacts operation | Snap action |
| Contacts material | Silver contacts |
| Maximum resistance across terminals | 25 MOhm conforming to IEC 255-7 category 3 25 mOhm conforming to NF C 93-050 method A |
| Short-circuit protection | 10 A cartridge fuse, type gG (gl) |
| Mechanical durability | 2000000 cycles |
| Setting | External |
| Height | 162 mm |
| Depth | 110 mm |
| Width | 110 mm |
| Net weight | 3.5 kg |

Environment

| | |
|---------------------------------------|--|
| Standards | UL 508 CE CSA C22.2 No 14 IEC 60947-5-1 |
| Product certifications | BV[RETURN]CCC[RETURN]LROS (Lloyds register of shipping) [RETURN]UL[RETURN]CSA |
| Protective treatment | TC standard version |
| Ambient air temperature for operation | -25...70 °C |
| Ambient air temperature for storage | -40...70 °C |
| Operating position | Any position |
| Vibration resistance | 4 gn conforming to IEC 60068-2-6 (f = 30...500 Hz) |
| Shock resistance | 50 gn conforming to IEC 60068-2-27 |
| Electrical shock protection class | Class I conforming to IEC 1140 Class I conforming to IEC 536 Class I conforming to NF C 20-030 |
| IP degree of protection | IP66 conforming to IEC 60529 |

Packing Units

| | |
|------------------------------|-----------|
| Unit Type of Package 1 | PCE |
| Number of Units in Package 1 | 1 |
| Package 1 Height | 15.500 cm |
| Package 1 Width | 15.500 cm |
| Package 1 Length | 16.000 cm |
| Package 1 Weight | 2.795 kg |
| Unit Type of Package 2 | S04 |
| Number of Units in Package 2 | 2 |
| Package 2 Height | 30.000 cm |
| Package 2 Width | 40.000 cm |
| Package 2 Length | 60.000 cm |
| Package 2 Weight | 6.841 kg |

Offer Sustainability

| | |
|--|---|
| Sustainable offer status | Green Premium product |
| Circularity Profile | No need of specific recycling operations |
| California proposition 65 | WARNING: This product can expose you to chemicals including: Diisononyl phthalate (DINP), which is known to the State of California to cause cancer, and Di-isodecyl phthalate (DIDP), which is known to the State of California to cause birth defects or other reproductive harm. For more information go to www.P65Warnings.ca.gov |
| For all Reach Rohs enquiries contact us at | sustainability@tesensors.com |

Contractual warranty

| | |
|----------|-----------|
| Warranty | 18 months |
|----------|-----------|

Dimensions

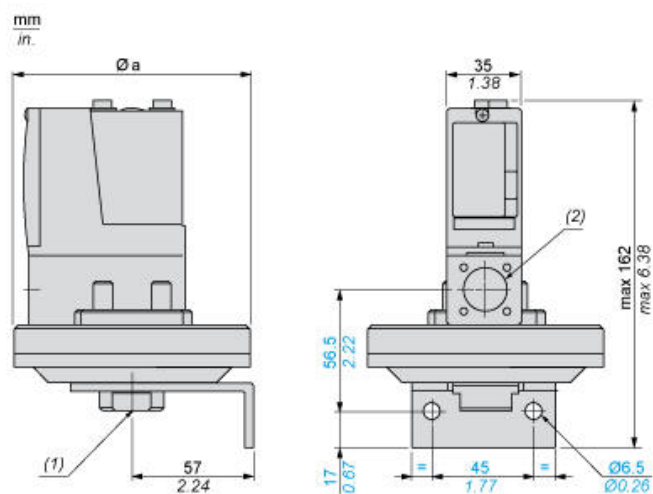

$\varnothing a = 110 \text{ mm} / 4.33 \text{ in.}$

(1) 1 fluid entry, tapped G1/4 (BSP female)

(2) 1 electrical connections entry, tapped Pg 13.5

Wiring Diagram

Terminal Model

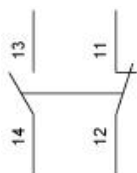

Operating Curves

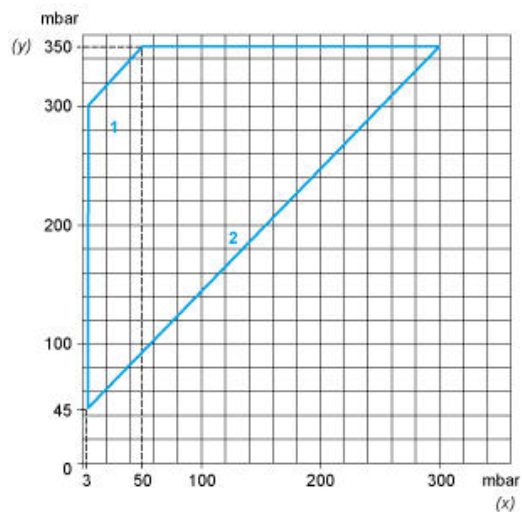

- (y) Rising pressure
(x) Falling pressure
1 : Maximum differential
2 : Minimum differential

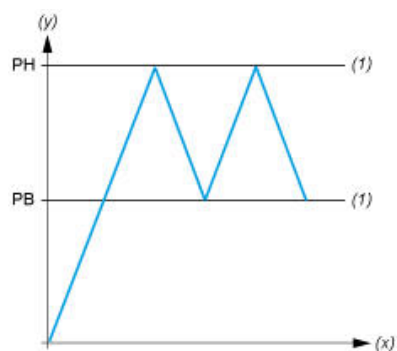

- (y) Pressure
(x) Time
(1) Adjustable value
PH : High point
PB : Below point